

Saulteau First Nation TLA Consultation Boucher Lake Road Site

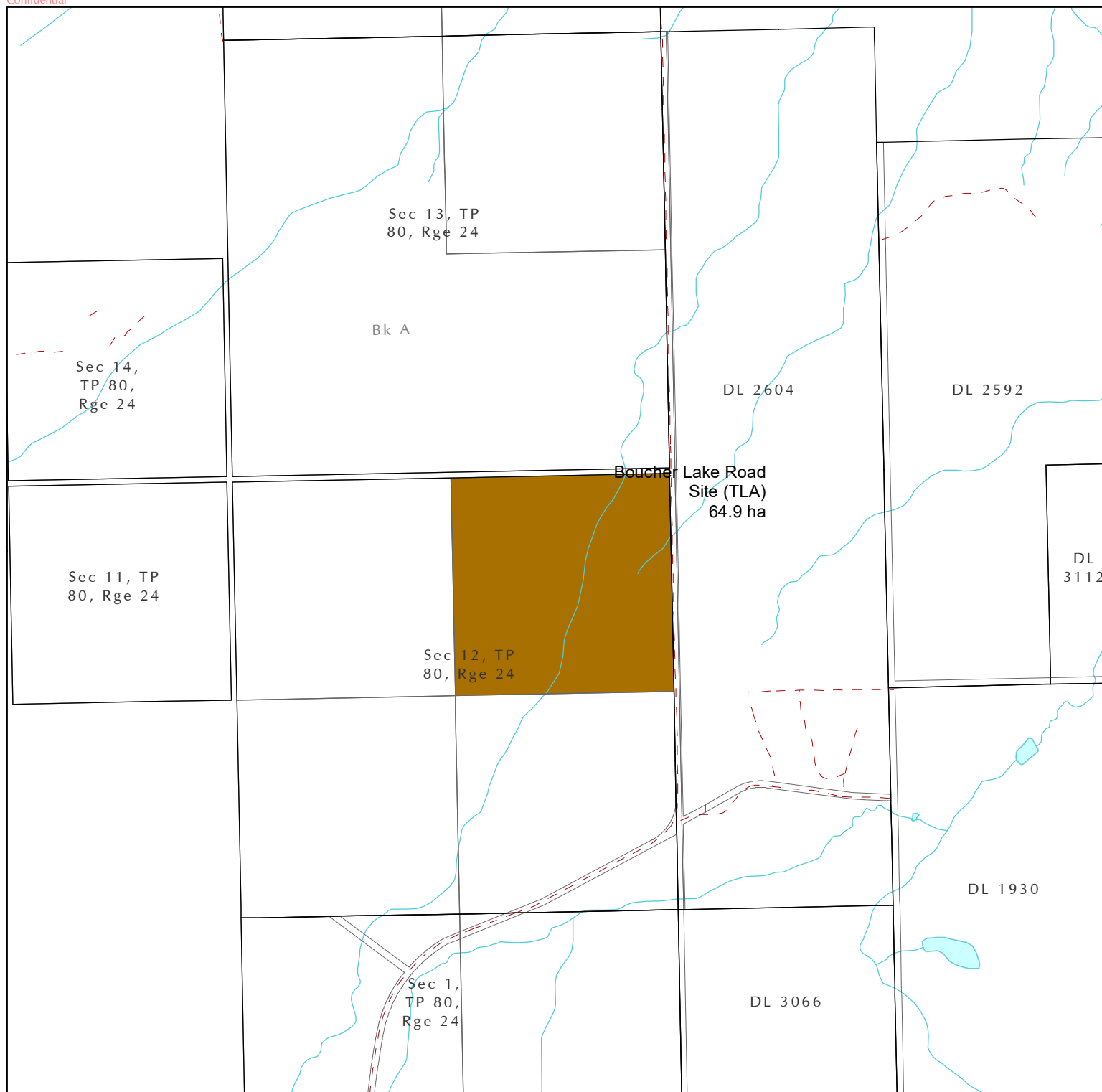

- TLA Area of Interest
- Saulteau Indian Reserve
- Other Indian Reserve
- Park or Protected Area

THE INFORMATION PRESENTED ON THIS MAP IS PROVIDED WITHOUT PREJUDICE FOR THE PURPOSES OF TREATY NEGOTIATIONS, IS SUBJECT TO FURTHER REVISIONS, AND DOES NOT CONSTITUTE A LEGAL DEFINITION.

DRAFT

1:20,000

0 0.5
Kilometres

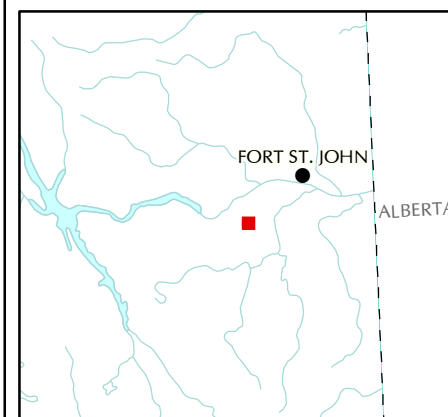

Produced by: GeoBC
Created by: Decision Support Section
Coordinate System: NAD 1983 UTM Zone 10N
Produced for:
Ministry of Indigenous Relations and Reconciliation

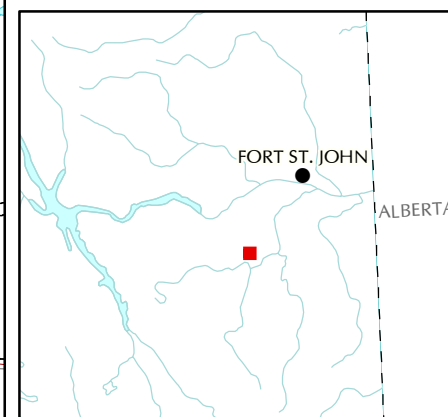
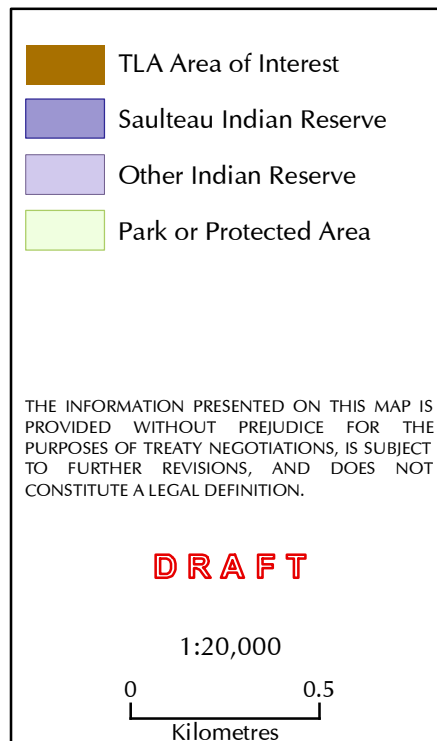

Produced by: GeoBC
Created by: Decision Support Section
Coordinate System: NAD 1983 UTM Zone 10N
Produced for:
Ministry of Indigenous Relations and Reconciliation

Saulteau First Nation TLA Consultation Chetwynd 2

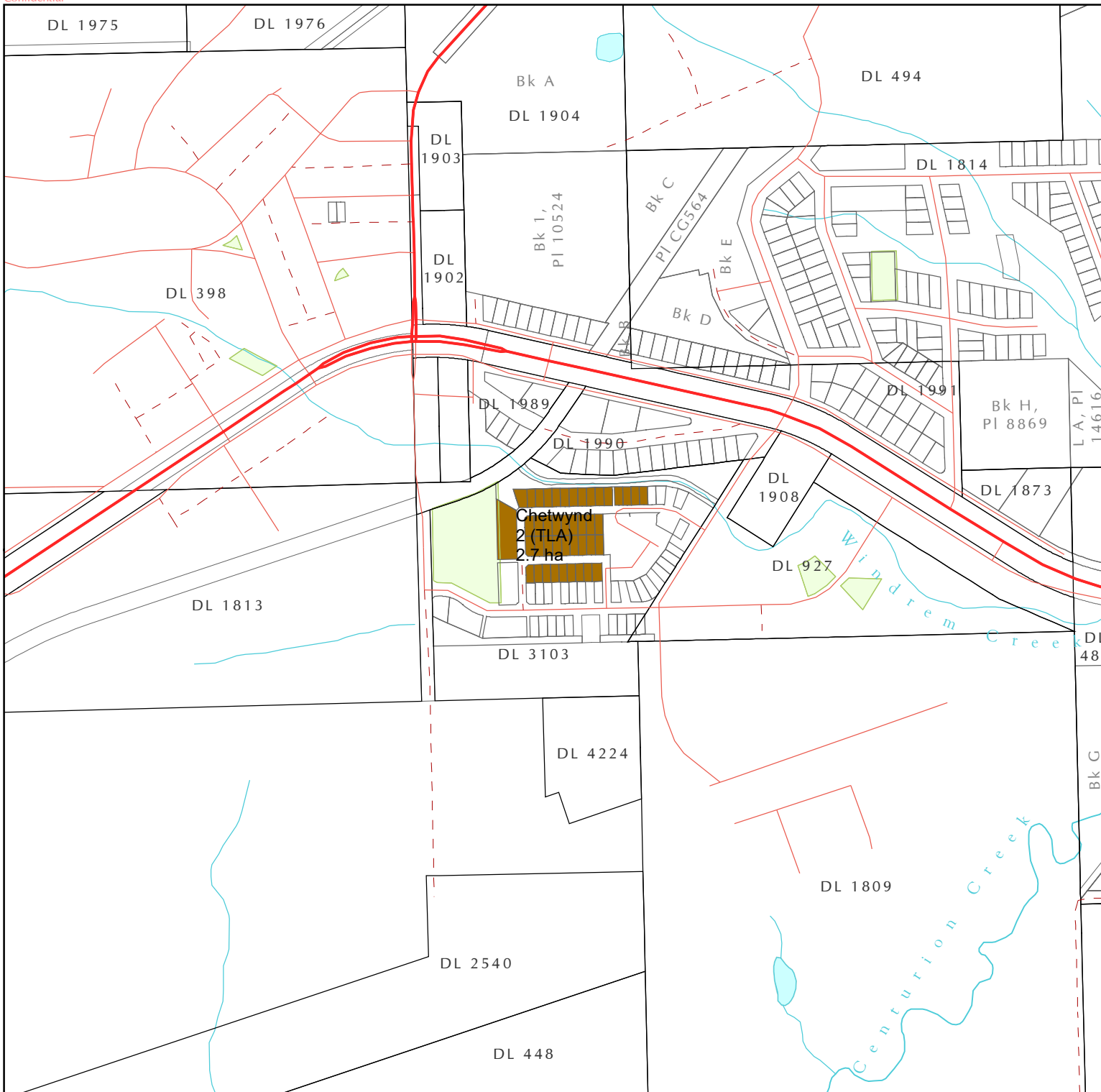

- TLA Area of Interest
- Saulteau Indian Reserve
- Other Indian Reserve
- Park or Protected Area

THE INFORMATION PRESENTED ON THIS MAP IS PROVIDED WITHOUT PREJUDICE FOR THE PURPOSES OF TREATY NEGOTIATIONS, IS SUBJECT TO FURTHER REVISIONS, AND DOES NOT CONSTITUTE A LEGAL DEFINITION.

DRAFT

1:10,000

0 0.35
Kilometres

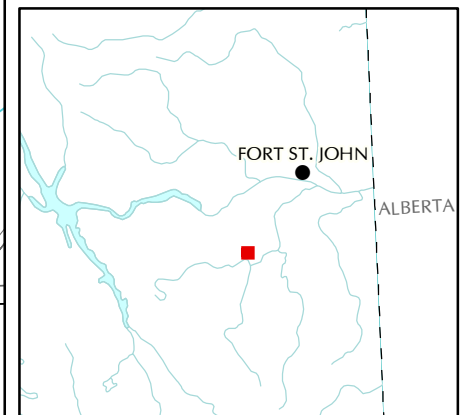

Produced by: GeoBC
Created by: Decision Support Section
Coordinate System: NAD 1983 UTM Zone 10N
Produced for:
Ministry of Indigenous Relations and Reconciliation

Saulteau First Nation TLA Consultation Chetwynd 3

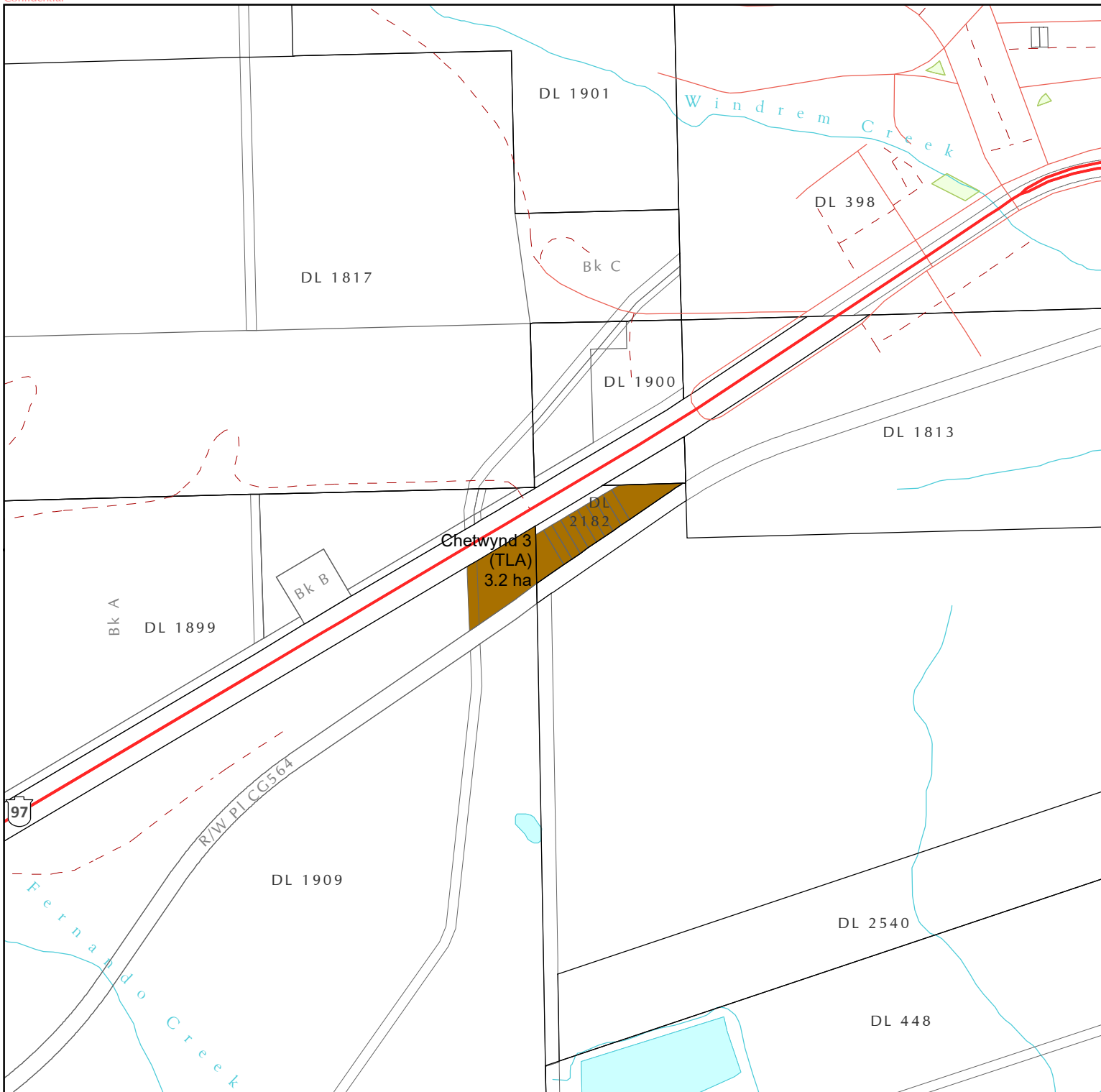

- TLA Area of Interest
- Saulteau Indian Reserve
- Other Indian Reserve
- Park or Protected Area

THE INFORMATION PRESENTED ON THIS MAP IS PROVIDED WITHOUT PREJUDICE FOR THE PURPOSES OF TREATY NEGOTIATIONS, IS SUBJECT TO FURTHER REVISIONS, AND DOES NOT CONSTITUTE A LEGAL DEFINITION.

DRAFT



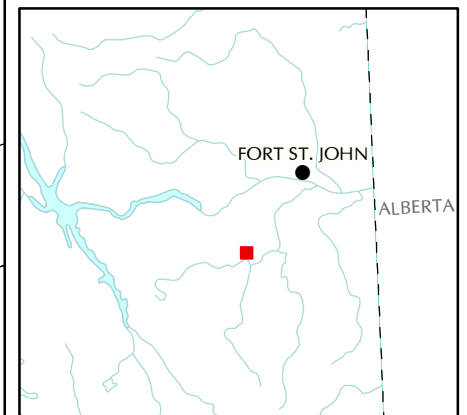

1:10,000

0 0.35
Kilometres



Produced by: GeoBC
Created by: Decision Support Section
Coordinate System: NAD 1983 UTM Zone 10N
Produced for:
Ministry of Indigenous Relations and Reconciliation

Saulteau First Nation TLA Consultation Chetwynd 4

-  TLA Area of Interest
-  Saulteau Indian Reserve
-  Other Indian Reserve
-  Park or Protected Area

THE INFORMATION PRESENTED ON THIS MAP IS PROVIDED WITHOUT PREJUDICE FOR THE PURPOSES OF TREATY NEGOTIATIONS, IS SUBJECT TO FURTHER REVISIONS, AND DOES NOT CONSTITUTE A LEGAL DEFINITION.

DRAFT



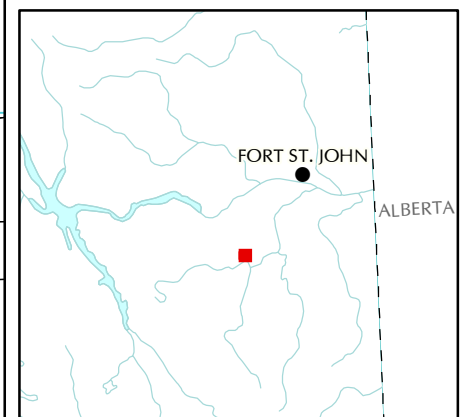

1:20,000

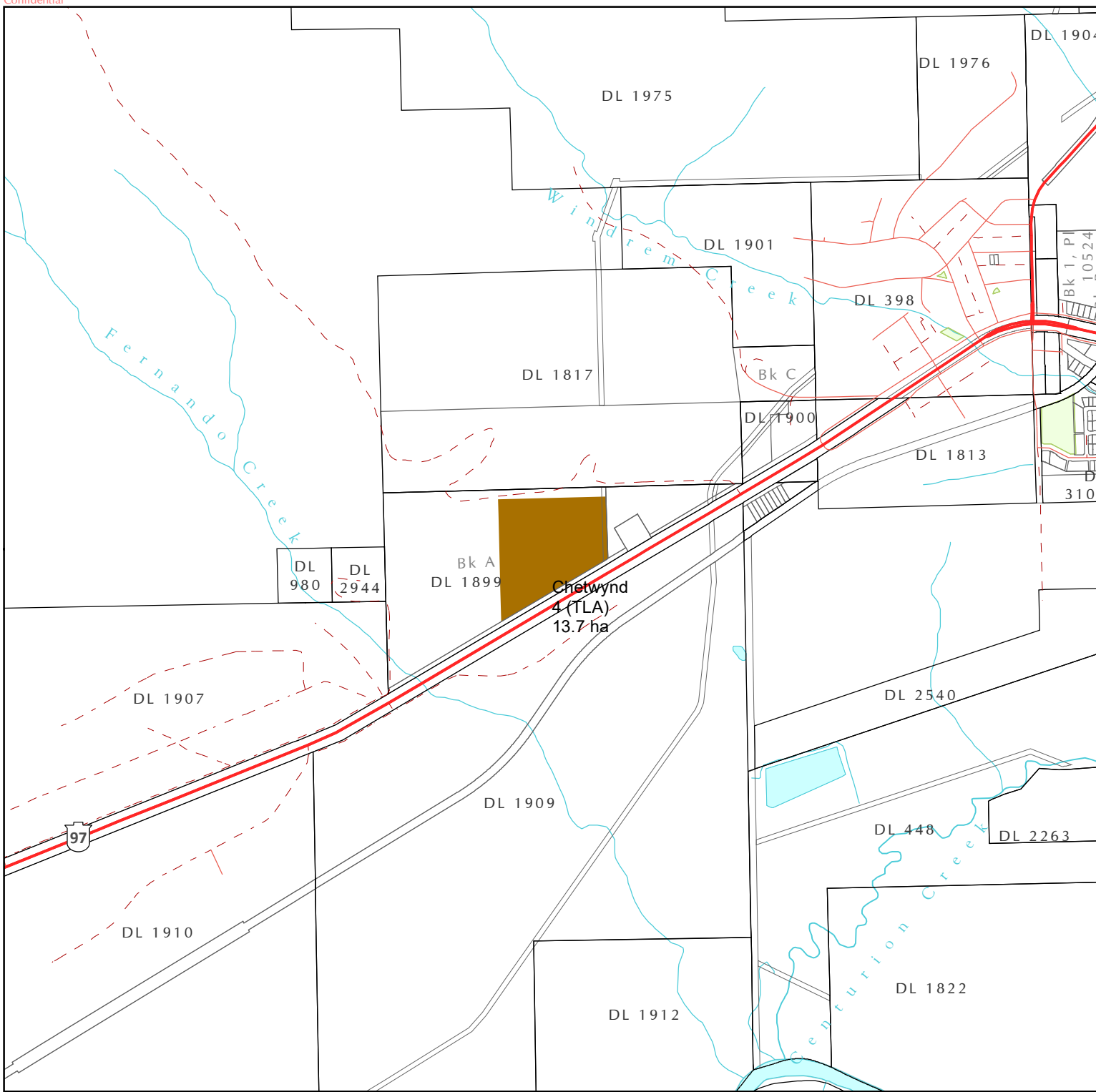

Produced by: GeoBC
Created by: Decision Support Section
Coordinate System: NAD 1983 UTM Zone 10N
Produced for:
Ministry of Indigenous Relations and Reconciliation



Saulteau First Nation TLA Consultation Chetwynd Railway Parcel 1

-  TLA Area of Interest
-  Saulteau Indian Reserve
-  Other Indian Reserve
-  Park or Protected Area

THE INFORMATION PRESENTED ON THIS MAP IS PROVIDED WITHOUT PREJUDICE FOR THE PURPOSES OF TREATY NEGOTIATIONS, IS SUBJECT TO FURTHER REVISIONS, AND DOES NOT CONSTITUTE A LEGAL DEFINITION.

DRAFT

1:20,000

0 0.5
Kilometres

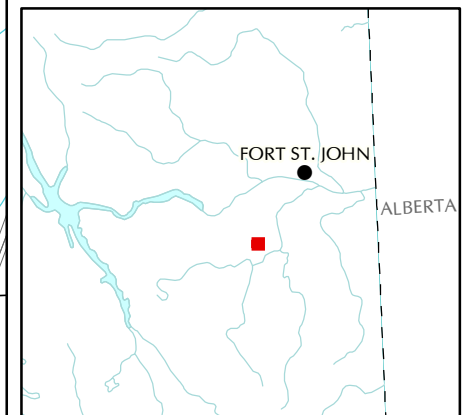

Produced by: GeoBC
Created by: Decision Support Section
Coordinate System: NAD 1983 UTM Zone 10N
Produced for:
Ministry of Indigenous Relations and Reconciliation

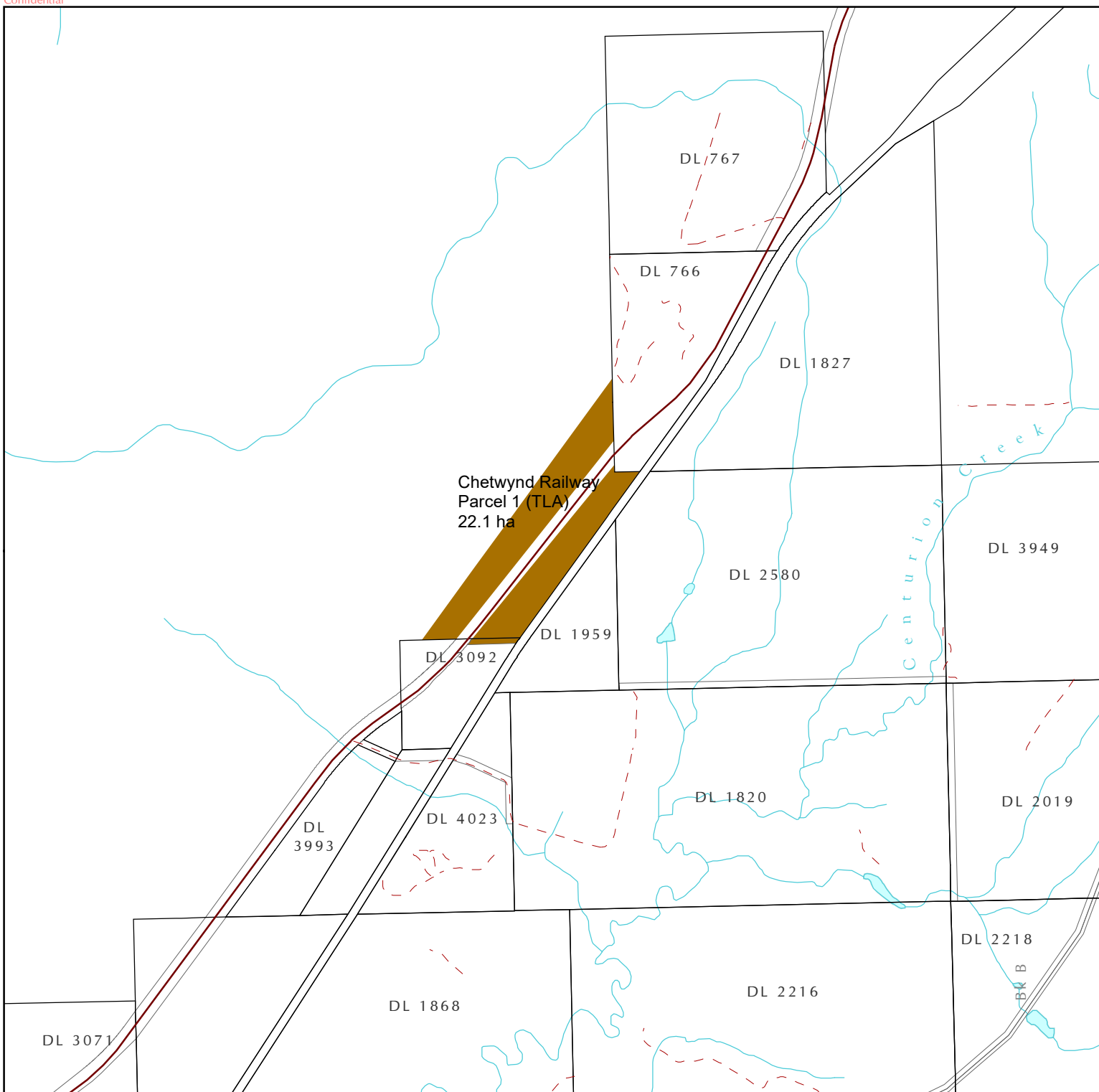

Saulteau First Nation TLA Consultation Chetwynd Railway Parcel 2

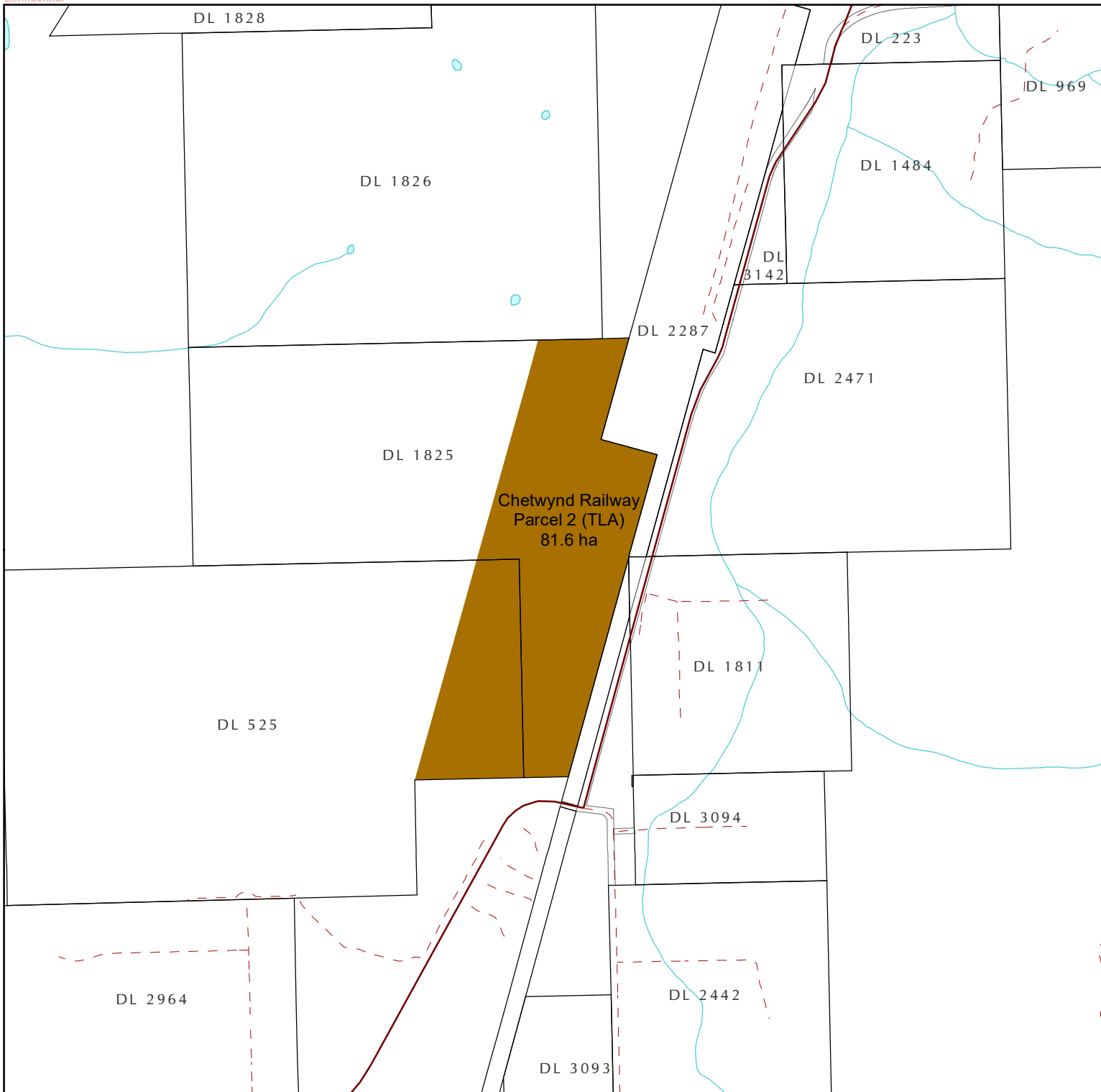

- TLA Area of Interest
- Saulteau Indian Reserve
- Other Indian Reserve
- Park or Protected Area

THE INFORMATION PRESENTED ON THIS MAP IS PROVIDED WITHOUT PREJUDICE FOR THE PURPOSES OF TREATY NEGOTIATIONS, IS SUBJECT TO FURTHER REVISIONS, AND DOES NOT CONSTITUTE A LEGAL DEFINITION.

DRAFT



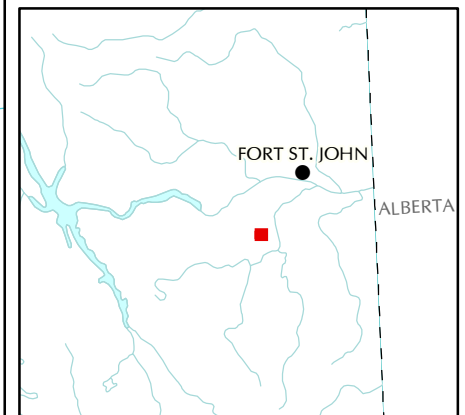

1:20,000

0 0.5
Kilometres



Produced by: GeoBC
Created by: Decision Support Section
Coordinate System: NAD 1983 UTM Zone 10N
Produced for:
Ministry of Indigenous Relations and Reconciliation

Saulteau First Nation TLA Consultation Halfmoon Lake

-  TLA Area of Interest
-  Saulteau Indian Reserve
-  Other Indian Reserve
-  Park or Protected Area

THE INFORMATION PRESENTED ON THIS MAP IS PROVIDED WITHOUT PREJUDICE FOR THE PURPOSES OF TREATY NEGOTIATIONS, IS SUBJECT TO FURTHER REVISIONS, AND DOES NOT CONSTITUTE A LEGAL DEFINITION.

DRAFT

1:20,000

0 0.5
Kilometres

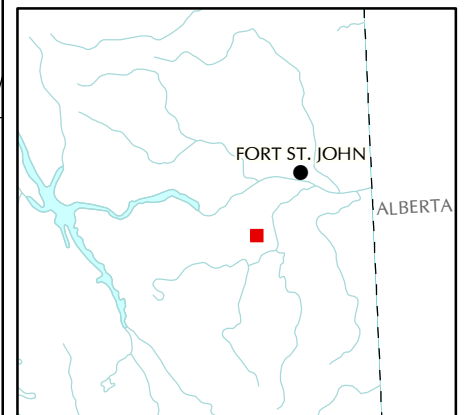

Produced by: GeoBC
Created by: Decision Support Section
Coordinate System: NAD 1983 UTM Zone 10N
Produced for:
Ministry of Indigenous Relations and Reconciliation

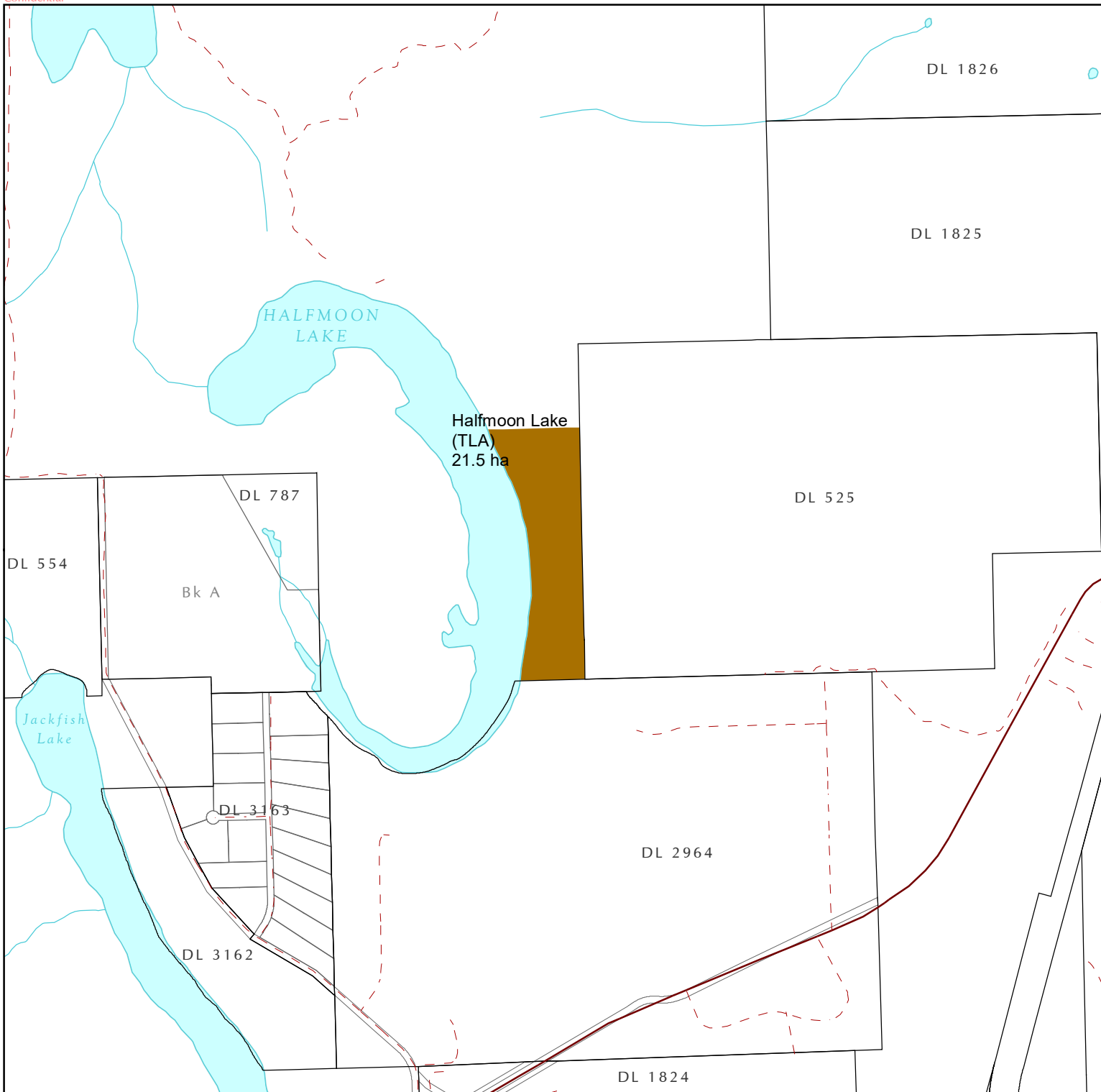

Saulteau First Nation TLA Consultation Hudson's Hope 1

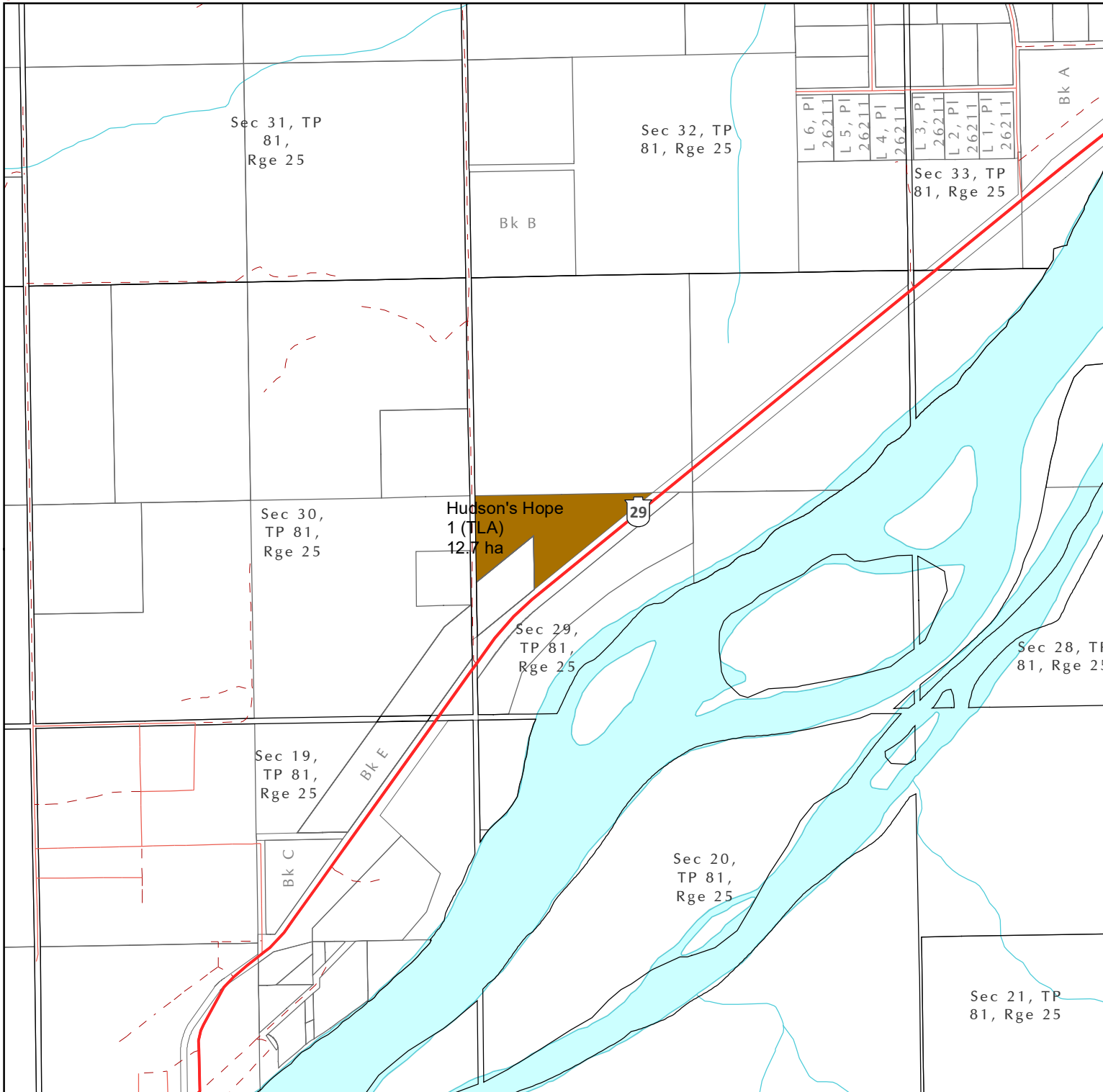

- TLA Area of Interest
- Saulteau Indian Reserve
- Other Indian Reserve
- Park or Protected Area

THE INFORMATION PRESENTED ON THIS MAP IS PROVIDED WITHOUT PREJUDICE FOR THE PURPOSES OF TREATY NEGOTIATIONS, IS SUBJECT TO FURTHER REVISIONS, AND DOES NOT CONSTITUTE A LEGAL DEFINITION.

DRAFT



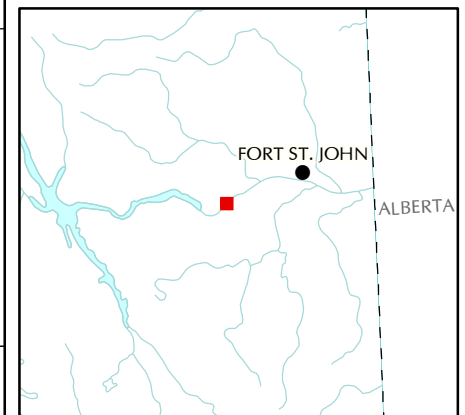

1:20,000

0 0.5
Kilometres



Produced by: GeoBC
Created by: Decision Support Section
Coordinate System: NAD 1983 UTM Zone 10N
Produced for:
Ministry of Indigenous Relations and Reconciliation

Saulteau First Nation TLA Consultation Km 50 South

-  TLA Area of Interest
-  Saulteau Indian Reserve
-  Other Indian Reserve
-  Park or Protected Area

THE INFORMATION PRESENTED ON THIS MAP IS PROVIDED WITHOUT PREJUDICE FOR THE PURPOSES OF TREATY NEGOTIATIONS, IS SUBJECT TO FURTHER REVISIONS, AND DOES NOT CONSTITUTE A LEGAL DEFINITION.

DRAFT



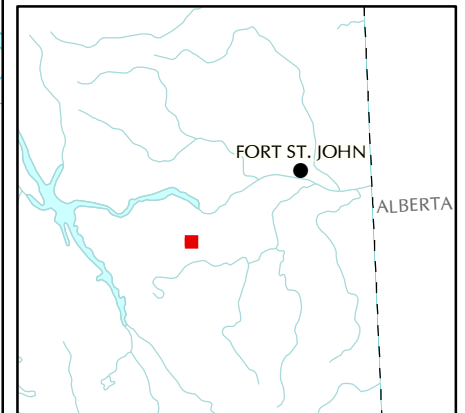

1:20,000

0 0.5
Kilometres



Produced by: GeoBC
Created by: Decision Support Section
Coordinate System: NAD 1983 UTM Zone 10N
Produced for:
Ministry of Indigenous Relations and Reconciliation

Saulteau First Nation TLA Consultation Little Lake

-  TLA Area of Interest
-  Saulteau Indian Reserve
-  Other Indian Reserve
-  Park or Protected Area

THE INFORMATION PRESENTED ON THIS MAP IS PROVIDED WITHOUT PREJUDICE FOR THE PURPOSES OF TREATY NEGOTIATIONS, IS SUBJECT TO FURTHER REVISIONS, AND DOES NOT CONSTITUTE A LEGAL DEFINITION.

DRAFT

1:20,000

0 0.5
Kilometres

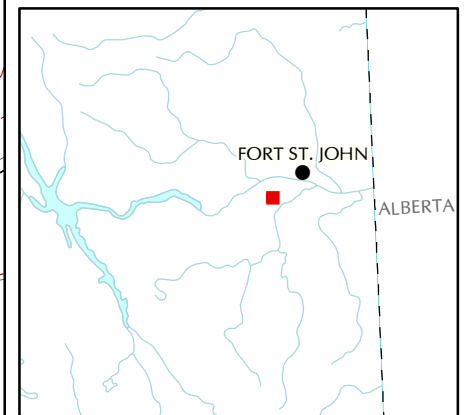
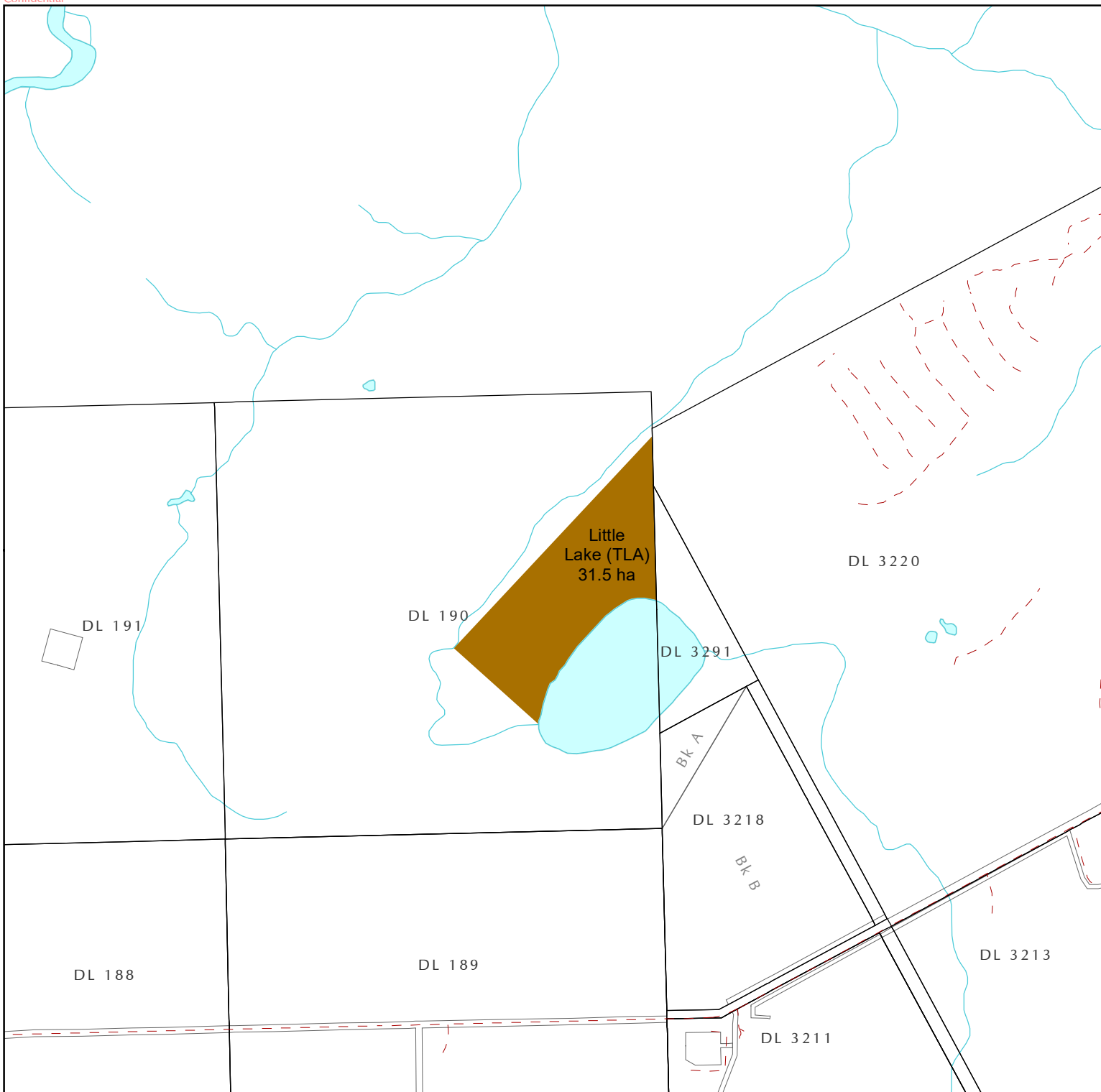

Produced by: GeoBC
Created by: Decision Support Section
Coordinate System: NAD 1983 UTM Zone 10N
Produced for:
Ministry of Indigenous Relations and Reconciliation

Saulteau First Nation TLA Consultation Mackenzie Junction

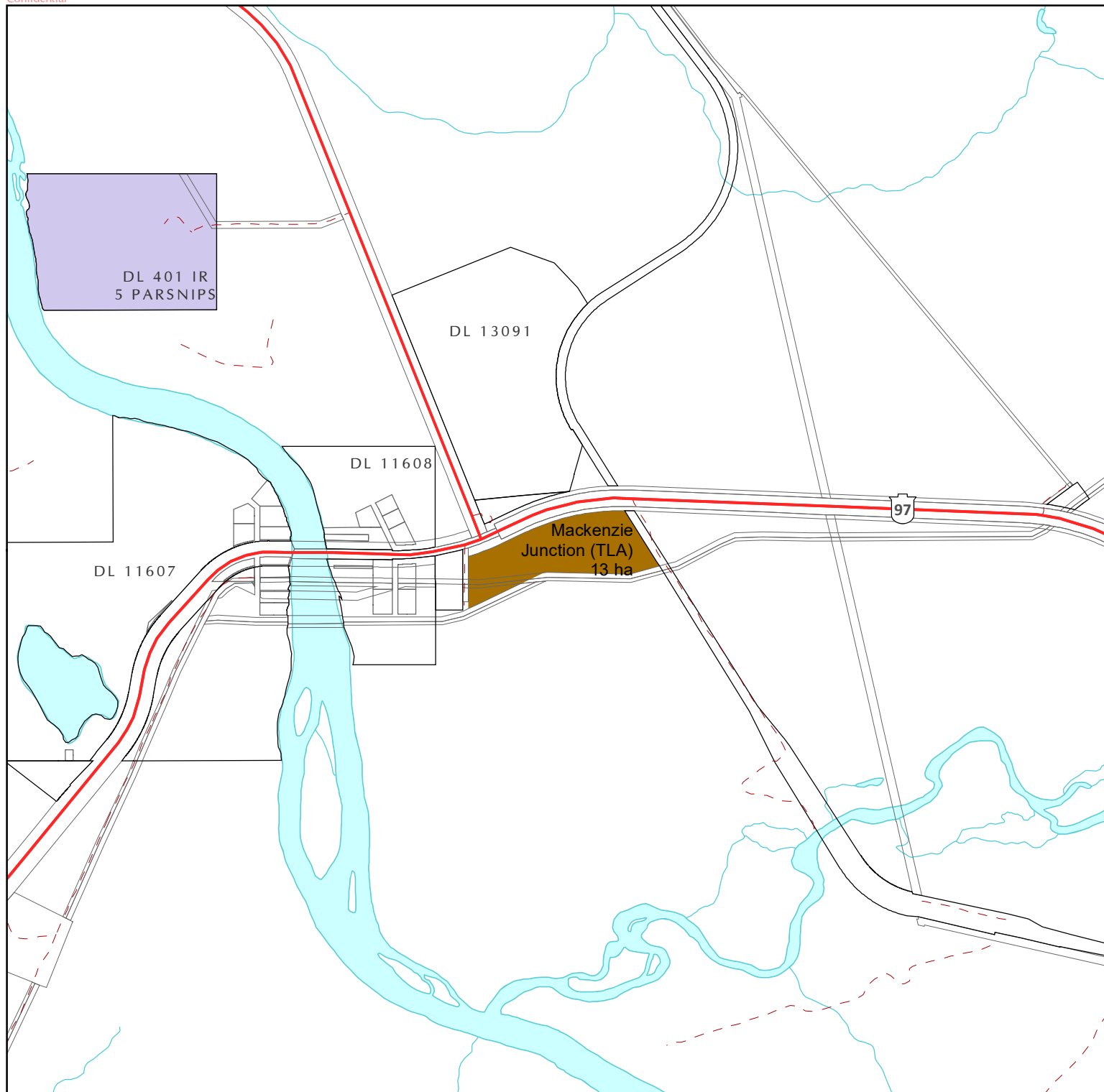

- TLA Area of Interest
- Saulteau Indian Reserve
- Other Indian Reserve
- Park or Protected Area

THE INFORMATION PRESENTED ON THIS MAP IS PROVIDED WITHOUT PREJUDICE FOR THE PURPOSES OF TREATY NEGOTIATIONS, IS SUBJECT TO FURTHER REVISIONS, AND DOES NOT CONSTITUTE A LEGAL DEFINITION.

DRAFT



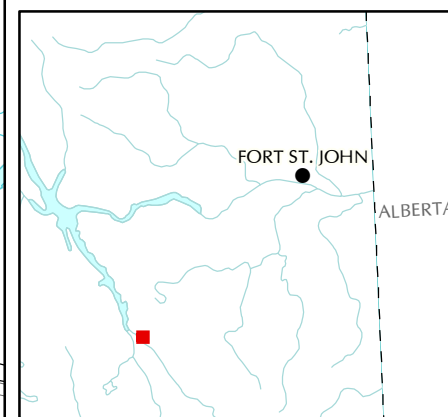

1:20,000

0 0.5
Kilometres



Produced by: GeoBC
Created by: Decision Support Section
Coordinate System: NAD 1983 UTM Zone 10N
Produced for:
Ministry of Indigenous Relations and Reconciliation

Saulteau First Nation TLA Consultation Murray River

-  TLA Area of Interest
-  Saulteau Indian Reserve
-  Other Indian Reserve
-  Park or Protected Area

THE INFORMATION PRESENTED ON THIS MAP IS PROVIDED WITHOUT PREJUDICE FOR THE PURPOSES OF TREATY NEGOTIATIONS, IS SUBJECT TO FURTHER REVISIONS, AND DOES NOT CONSTITUTE A LEGAL DEFINITION.

DRAFT



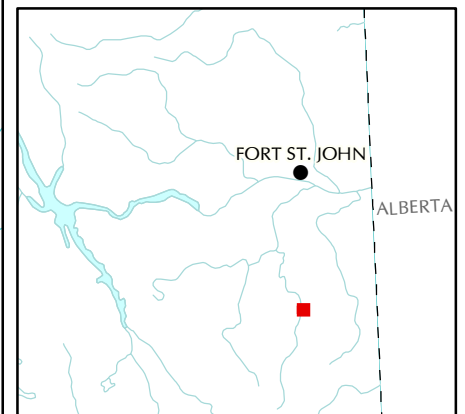

1:20,000

0 0.5
Kilometres



Produced by: GeoBC
Created by: Decision Support Section
Coordinate System: NAD 1983 UTM Zone 10N
Produced for:
Ministry of Indigenous Relations and Reconciliation

Saulteau First Nation TLA Consultation Rene Lake

-  TLA Area of Interest
-  Saulteau Indian Reserve
-  Other Indian Reserve
-  Park or Protected Area

THE INFORMATION PRESENTED ON THIS MAP IS PROVIDED WITHOUT PREJUDICE FOR THE PURPOSES OF TREATY NEGOTIATIONS, IS SUBJECT TO FURTHER REVISIONS, AND DOES NOT CONSTITUTE A LEGAL DEFINITION.

DRAFT

1:50,000

0 0.5 1 1.5
Kilometres

Sec 35, TP
80,
Rge 24

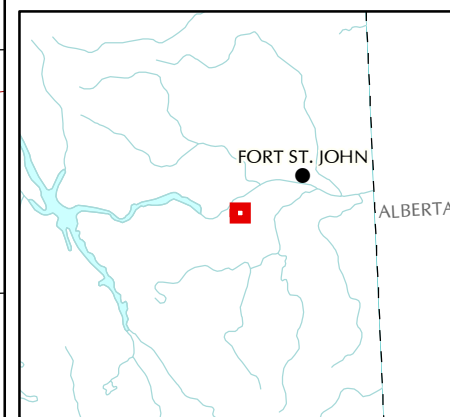

Produced by: GeoBC
Created by: Decision Support Section
Coordinate System: NAD 1983 UTM Zone 10N
Produced for:
Ministry of Indigenous Relations and Reconciliation

Saulteau First Nation TLA Consultation Stewart Lake

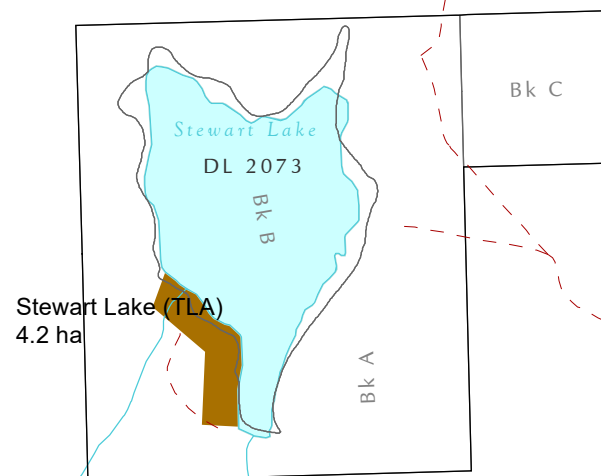

- TLA Area of Interest
- Saulteau Indian Reserve
- Other Indian Reserve
- Park or Protected Area

THE INFORMATION PRESENTED ON THIS MAP IS PROVIDED WITHOUT PREJUDICE FOR THE PURPOSES OF TREATY NEGOTIATIONS, IS SUBJECT TO FURTHER REVISIONS, AND DOES NOT CONSTITUTE A LEGAL DEFINITION.

DRAFT



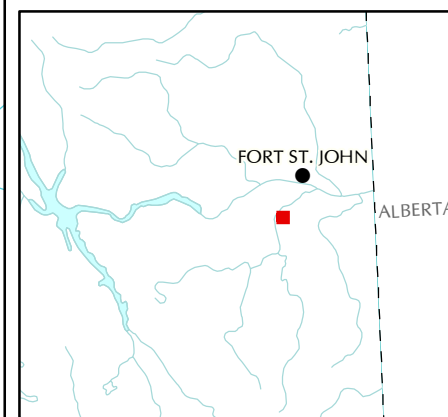

1:20,000

0 0.5
Kilometres



Produced by: GeoBC
Created by: Decision Support Section
Coordinate System: NAD 1983 UTM Zone 10N
Produced for:
Ministry of Indigenous Relations and Reconciliation

Saulteau First Nation TLA Consultation Trapper Creek

-  TLA Area of Interest
-  Saulteau Indian Reserve
-  Other Indian Reserve
-  Park or Protected Area

THE INFORMATION PRESENTED ON THIS MAP IS PROVIDED WITHOUT PREJUDICE FOR THE PURPOSES OF TREATY NEGOTIATIONS, IS SUBJECT TO FURTHER REVISIONS, AND DOES NOT CONSTITUTE A LEGAL DEFINITION.

DRAFT

1:20,000

0 0.5
Kilometres

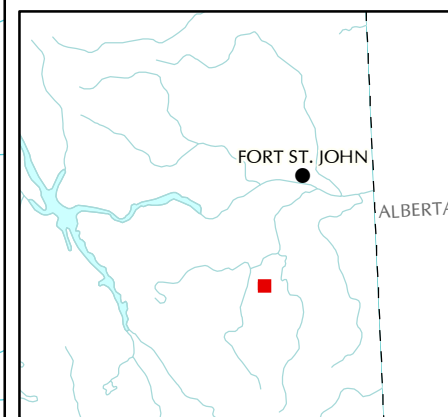

Produced by: GeoBC
Created by: Decision Support Section
Coordinate System: NAD 1983 UTM Zone 10N
Produced for:
Ministry of Indigenous Relations and Reconciliation

Saulteau First Nation TLA Consultation Tumbler Ridge 1

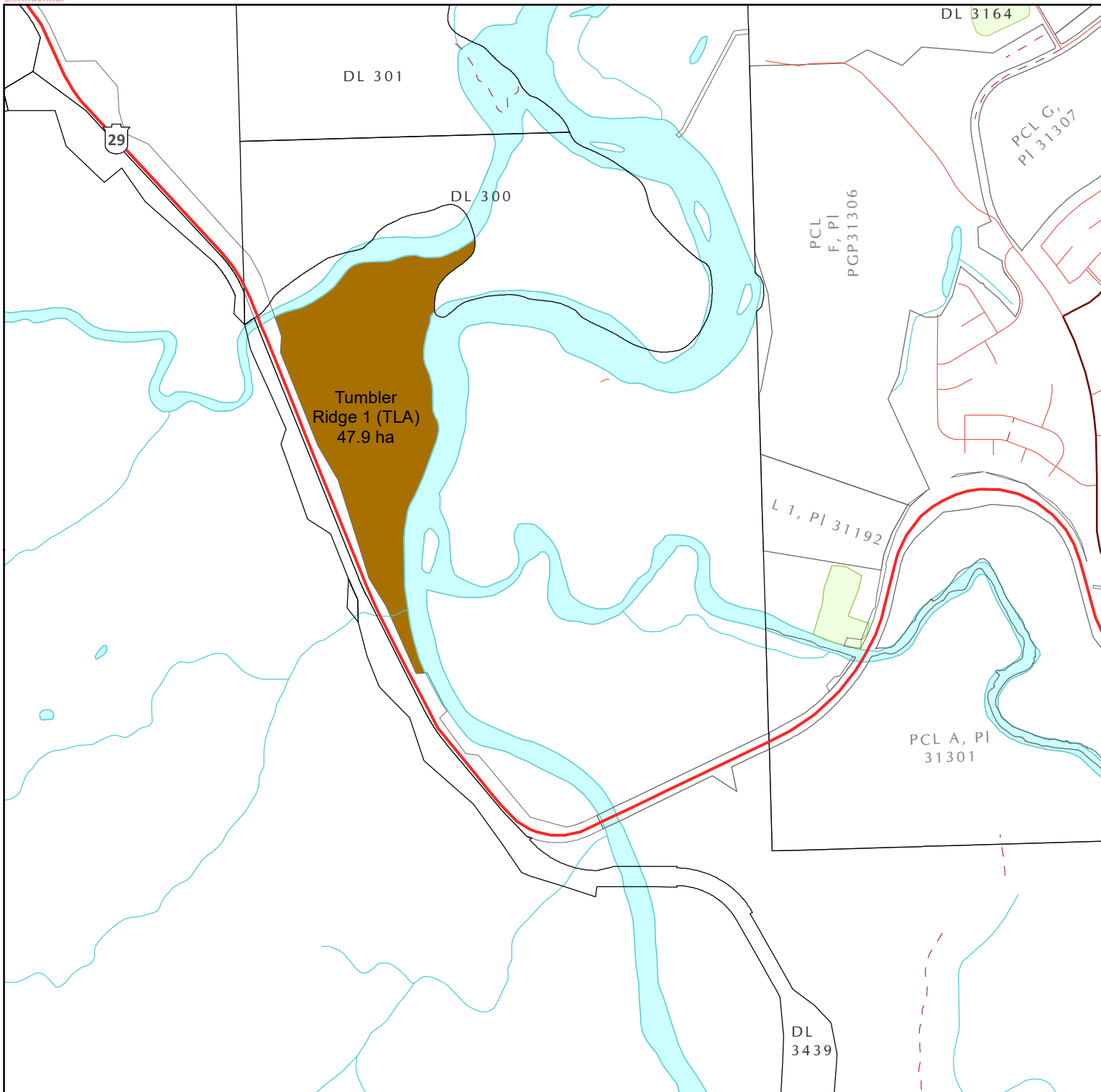

- TLA Area of Interest
- Saulteau Indian Reserve
- Other Indian Reserve
- Park or Protected Area

THE INFORMATION PRESENTED ON THIS MAP IS PROVIDED WITHOUT PREJUDICE FOR THE PURPOSES OF TREATY NEGOTIATIONS, IS SUBJECT TO FURTHER REVISIONS, AND DOES NOT CONSTITUTE A LEGAL DEFINITION.

DRAFT

1:20,000

0 0.5
Kilometres

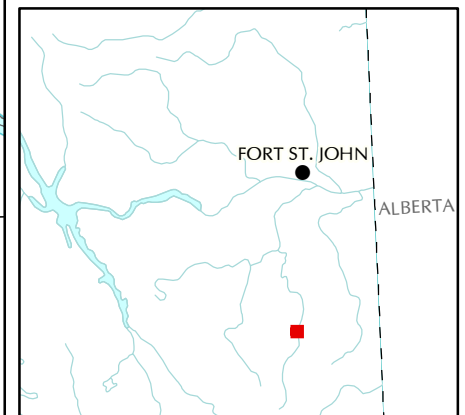

Produced by: GeoBC
Created by: Decision Support Section
Coordinate System: NAD 1983 UTM Zone 10N
Produced for:
Ministry of Indigenous Relations and Reconciliation

Saulteau First Nation TLA Consultation Tumbler Ridge 2

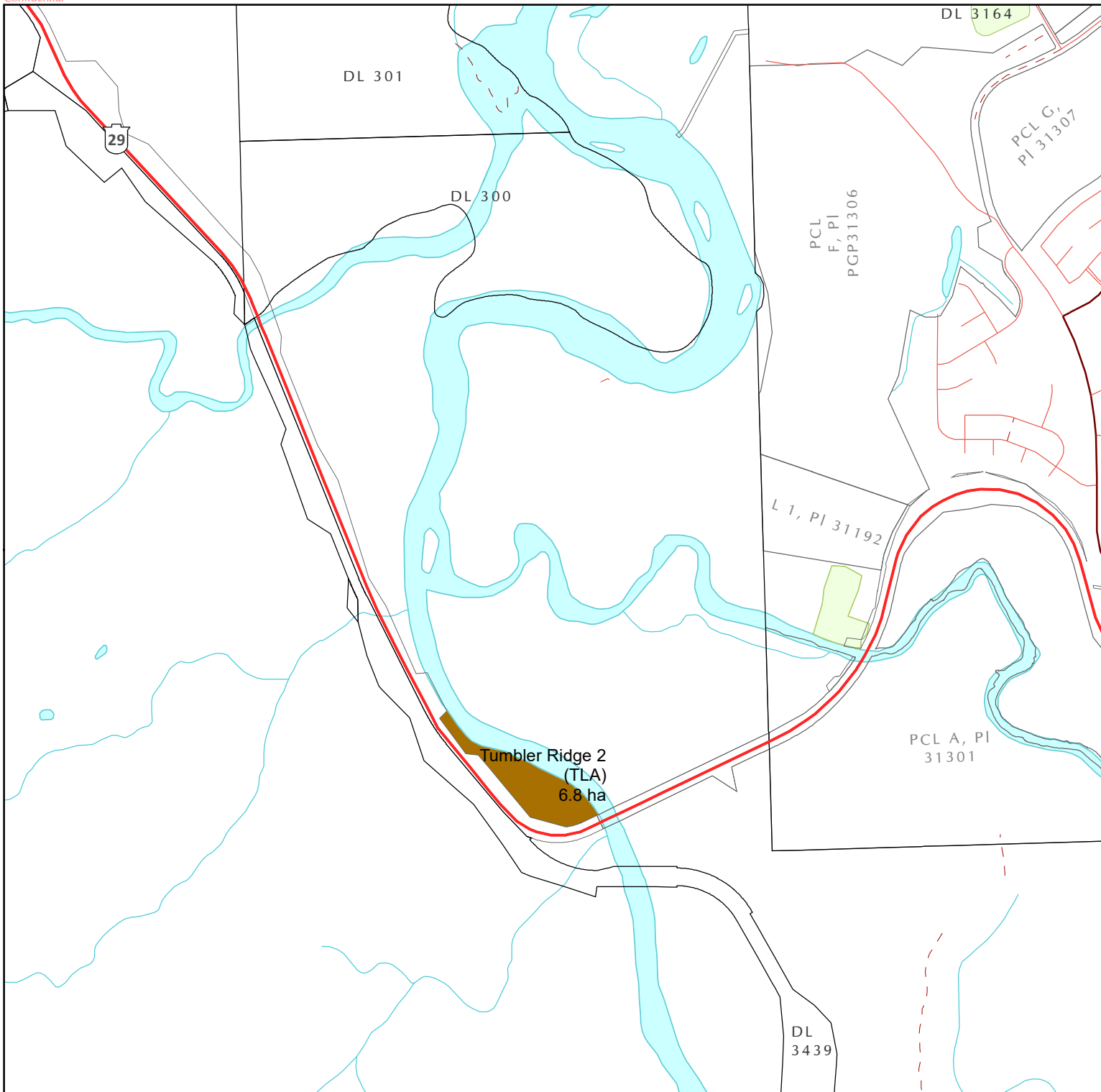

- TLA Area of Interest
- Saulteau Indian Reserve
- Other Indian Reserve
- Park or Protected Area

THE INFORMATION PRESENTED ON THIS MAP IS PROVIDED WITHOUT PREJUDICE FOR THE PURPOSES OF TREATY NEGOTIATIONS, IS SUBJECT TO FURTHER REVISIONS, AND DOES NOT CONSTITUTE A LEGAL DEFINITION.

DRAFT

1:20,000

0 0.5
Kilometres

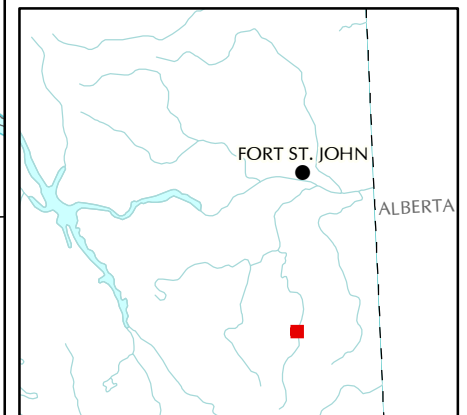

Produced by: GeoBC
Created by: Decision Support Section
Coordinate System: NAD 1983 UTM Zone 10N
Produced for:
Ministry of Indigenous Relations and Reconciliation

Saulteau First Nation TLA Consultation Tumbler Ridge 3

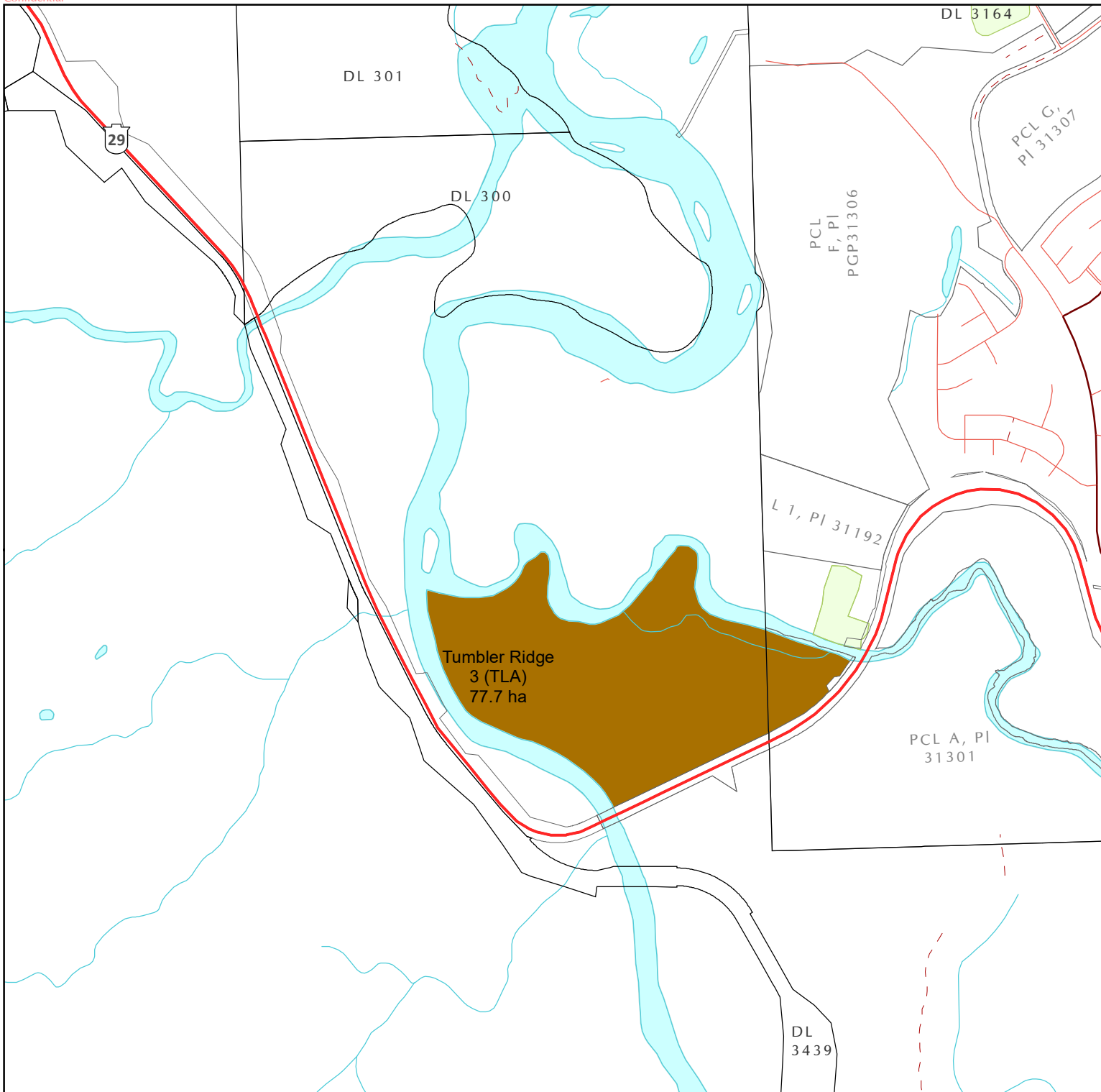

- TLA Area of Interest
- Saulteau Indian Reserve
- Other Indian Reserve
- Park or Protected Area

THE INFORMATION PRESENTED ON THIS MAP IS PROVIDED WITHOUT PREJUDICE FOR THE PURPOSES OF TREATY NEGOTIATIONS, IS SUBJECT TO FURTHER REVISIONS, AND DOES NOT CONSTITUTE A LEGAL DEFINITION.

DRAFT

1:20,000

0 0.5
Kilometres

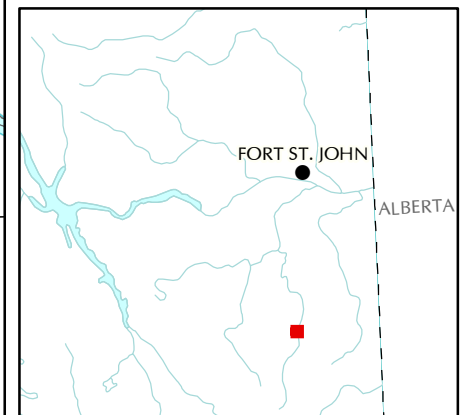

Produced by: GeoBC
Created by: Decision Support Section
Coordinate System: NAD 1983 UTM Zone 10N
Produced for:
Ministry of Indigenous Relations and Reconciliation

Saulteau First Nation TLA Consultation Tumbler Ridge 4

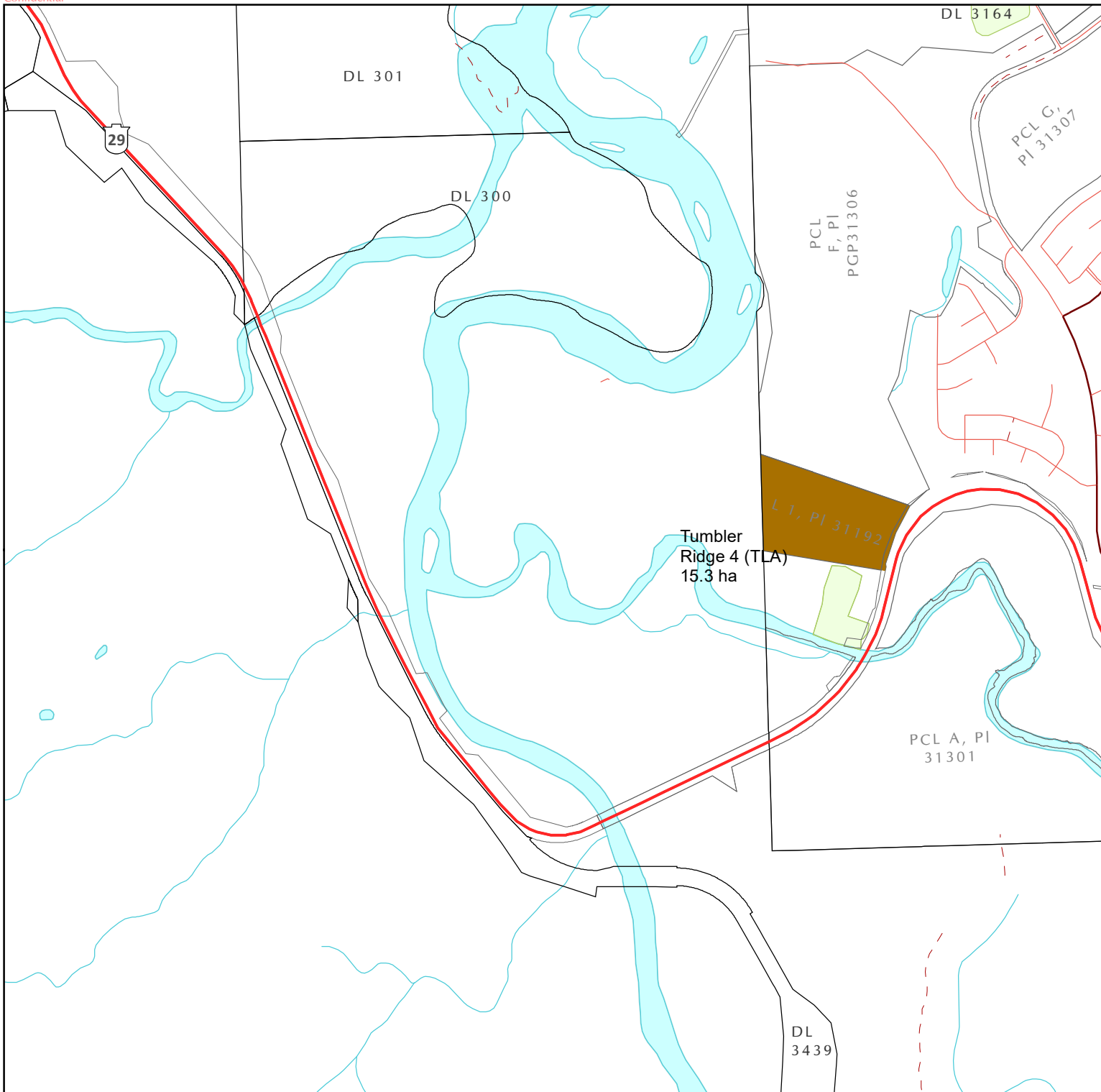

- TLA Area of Interest
- Saulteau Indian Reserve
- Other Indian Reserve
- Park or Protected Area

THE INFORMATION PRESENTED ON THIS MAP IS PROVIDED WITHOUT PREJUDICE FOR THE PURPOSES OF TREATY NEGOTIATIONS, IS SUBJECT TO FURTHER REVISIONS, AND DOES NOT CONSTITUTE A LEGAL DEFINITION.

DRAFT

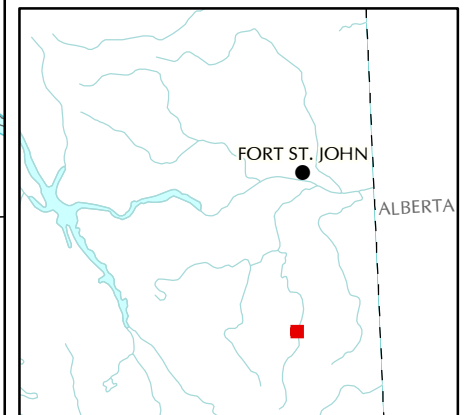

1:20,000

0 0.5
Kilometres



Produced by: GeoBC
Created by: Decision Support Section
Coordinate System: NAD 1983 UTM Zone 10N
Produced for:
Ministry of Indigenous Relations and Reconciliation

Saulteau First Nation TLA Consultation Twin Sisters Nursery Expansion

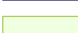
-  TLA Area of Interest
-  Saulteau Indian Reserve
-  Other Indian Reserve
-  Park or Protected Area

THE INFORMATION PRESENTED ON THIS MAP IS PROVIDED WITHOUT PREJUDICE FOR THE PURPOSES OF TREATY NEGOTIATIONS, IS SUBJECT TO FURTHER REVISIONS, AND DOES NOT CONSTITUTE A LEGAL DEFINITION.

DRAFT



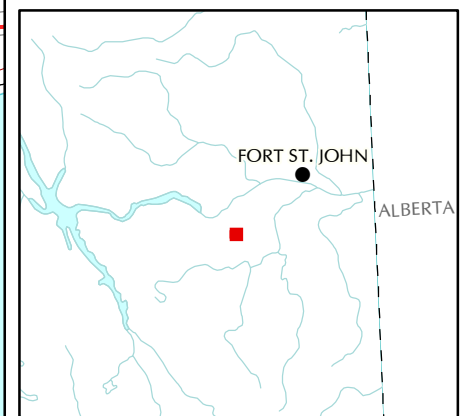
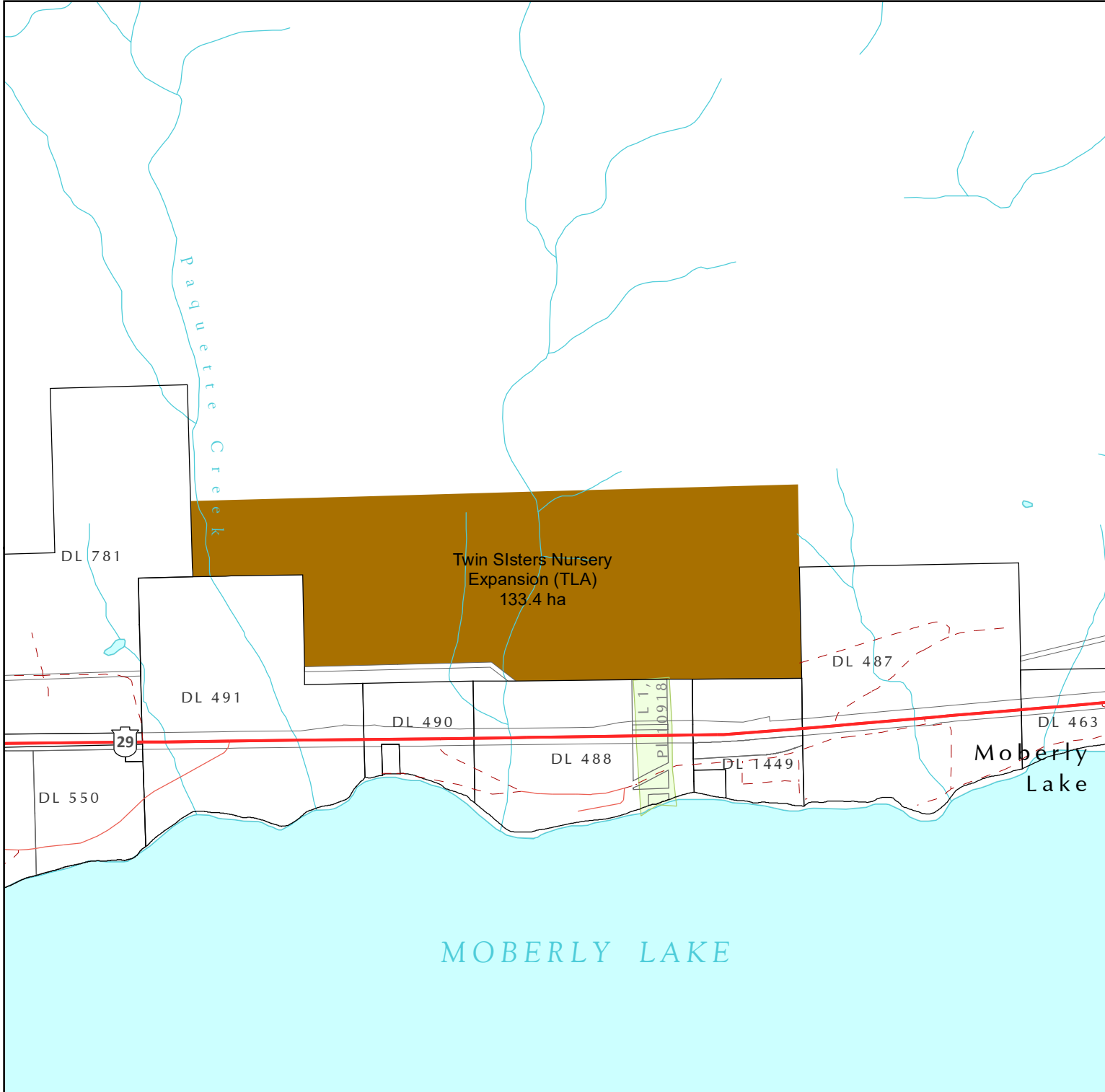

1:20,000

0 0.5
Kilometres



Produced by: GeoBC
Created by: Decision Support Section
Coordinate System: NAD 1983 UTM Zone 10N
Produced for:
Ministry of Indigenous Relations and Reconciliation

Saulteau First Nation TLA Consultation Wapiti West

-  TLA Area of Interest
-  Saulteau Indian Reserve
-  Other Indian Reserve
-  Park or Protected Area

THE INFORMATION PRESENTED ON THIS MAP IS PROVIDED WITHOUT PREJUDICE FOR THE PURPOSES OF TREATY NEGOTIATIONS, IS SUBJECT TO FURTHER REVISIONS, AND DOES NOT CONSTITUTE A LEGAL DEFINITION.

DRAFT



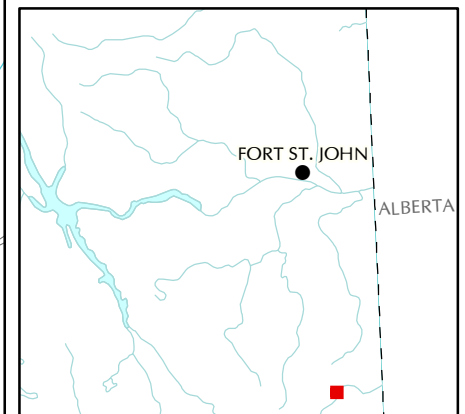

1:20,000

0 0.5
Kilometres



Produced by: GeoBC
Created by: Decision Support Section
Coordinate System: NAD 1983 UTM Zone 10N
Produced for:
Ministry of Indigenous Relations and Reconciliation

Saulteau First Nation TLA Consultation Williston

-  TLA Area of Interest
-  Saulteau Indian Reserve
-  Other Indian Reserve
-  Park or Protected Area

THE INFORMATION PRESENTED ON THIS MAP IS PROVIDED WITHOUT PREJUDICE FOR THE PURPOSES OF TREATY NEGOTIATIONS, IS SUBJECT TO FURTHER REVISIONS, AND DOES NOT CONSTITUTE A LEGAL DEFINITION.

DRAFT

1:20,000



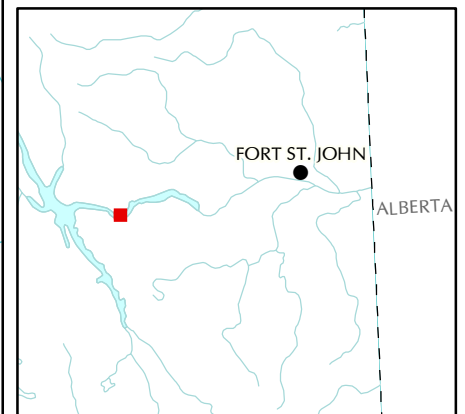

0 0.5
Kilometres



Produced by: GeoBC
Created by: Decision Support Section
Coordinate System: NAD 1983 UTM Zone 10N
Produced for:
Ministry of Indigenous Relations and Reconciliation



Saulteau First Nation TLA Consultation Moberly Lake Reserve Expansion 1

-  TLA Area of Interest
-  Saulteau Indian Reserve
-  Other Indian Reserve
-  Park or Protected Area

THE INFORMATION PRESENTED ON THIS MAP IS PROVIDED WITHOUT PREJUDICE FOR THE PURPOSES OF TREATY NEGOTIATIONS, IS SUBJECT TO FURTHER REVISIONS, AND DOES NOT CONSTITUTE A LEGAL DEFINITION.



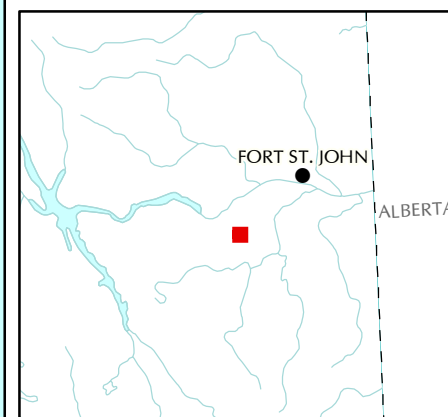
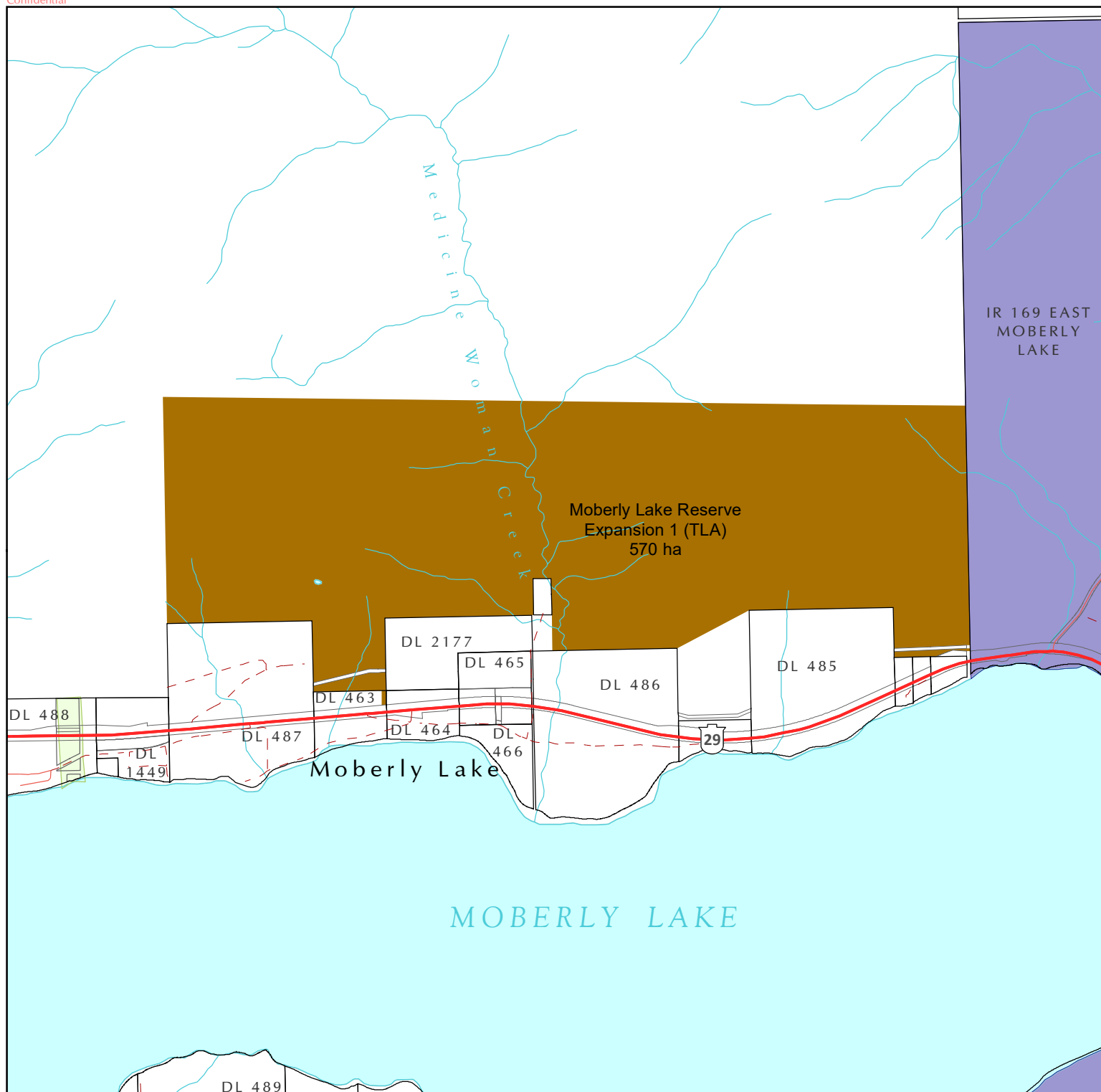
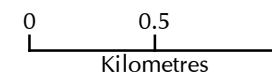

DRAFT

1:30,000



Produced by: GeoBC
Created by: Decision Support Section
Coordinate System: NAD 1983 UTM Zone 10N
Produced for:
Ministry of Indigenous Relations and Reconciliation

Saulteau First Nation TLA Consultation Moberly Lake Reserve Expansion 2

-  TLA Area of Interest
-  Saulteau Indian Reserve
-  Other Indian Reserve
-  Park or Protected Area

THE INFORMATION PRESENTED ON THIS MAP IS PROVIDED WITHOUT PREJUDICE FOR THE PURPOSES OF TREATY NEGOTIATIONS, IS SUBJECT TO FURTHER REVISIONS, AND DOES NOT CONSTITUTE A LEGAL DEFINITION.

DRAFT



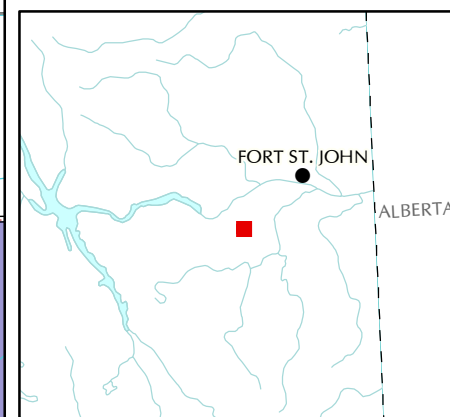
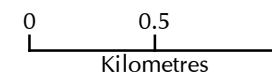

1:30,000

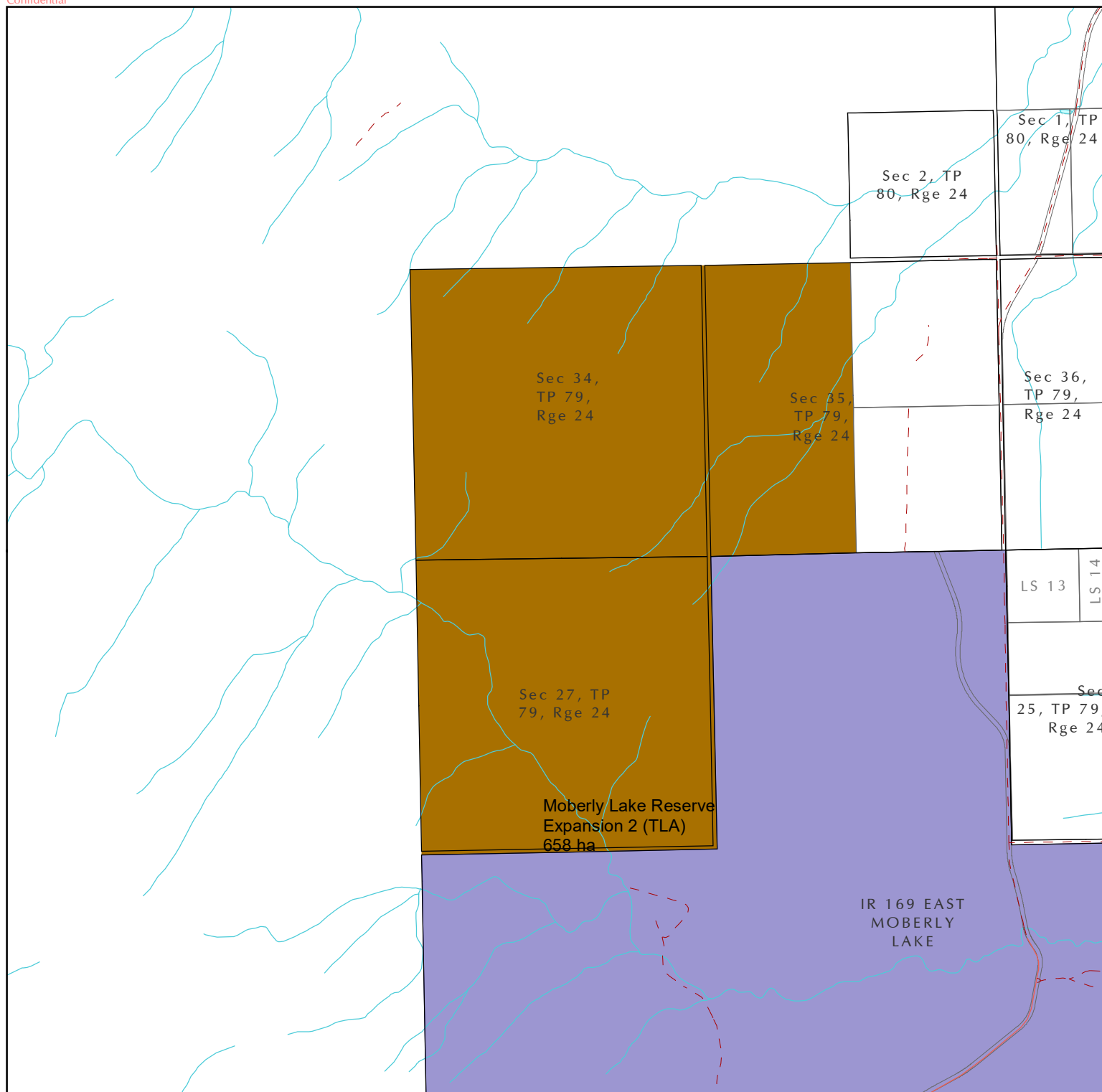

Produced by: GeoBC
Created by: Decision Support Section
Coordinate System: NAD 1983 UTM Zone 10N
Produced for:
Ministry of Indigenous Relations and Reconciliation



Saulteau First Nation TLA Consultation Moberly Lake Reserve Expansion 3

-  TLA Area of Interest
-  Saulteau Indian Reserve
-  Other Indian Reserve
-  Park or Protected Area

THE INFORMATION PRESENTED ON THIS MAP IS PROVIDED WITHOUT PREJUDICE FOR THE PURPOSES OF TREATY NEGOTIATIONS, IS SUBJECT TO FURTHER REVISIONS, AND DOES NOT CONSTITUTE A LEGAL DEFINITION.

DRAFT

1:75,000

0 0.5 1 1.5
Kilometres

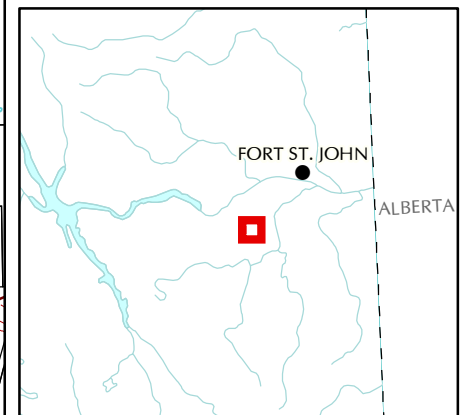

Produced by: GeoBC
Created by: Decision Support Section
Coordinate System: NAD 1983 UTM Zone 10N
Produced for:
Ministry of Indigenous Relations and Reconciliation

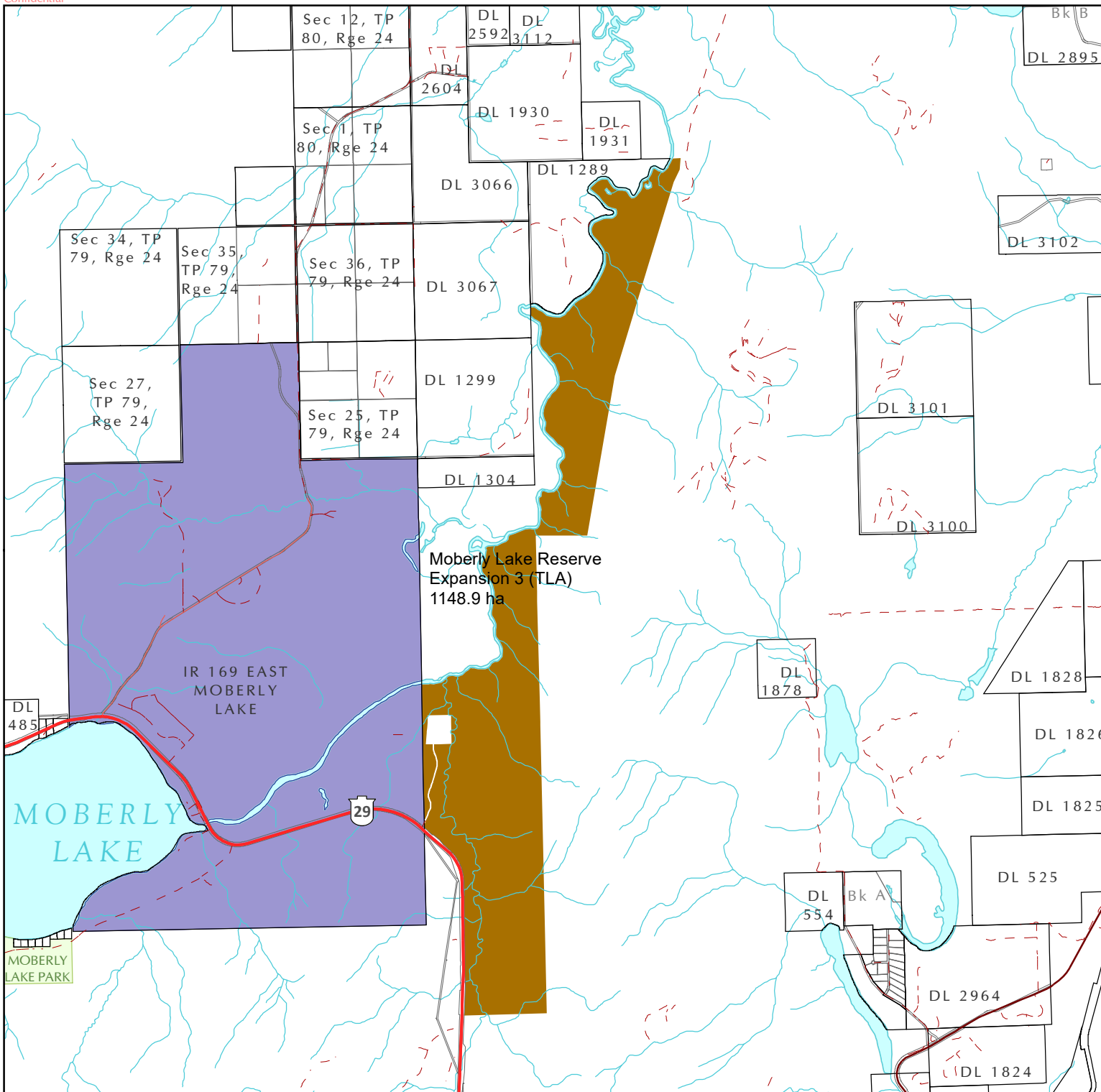

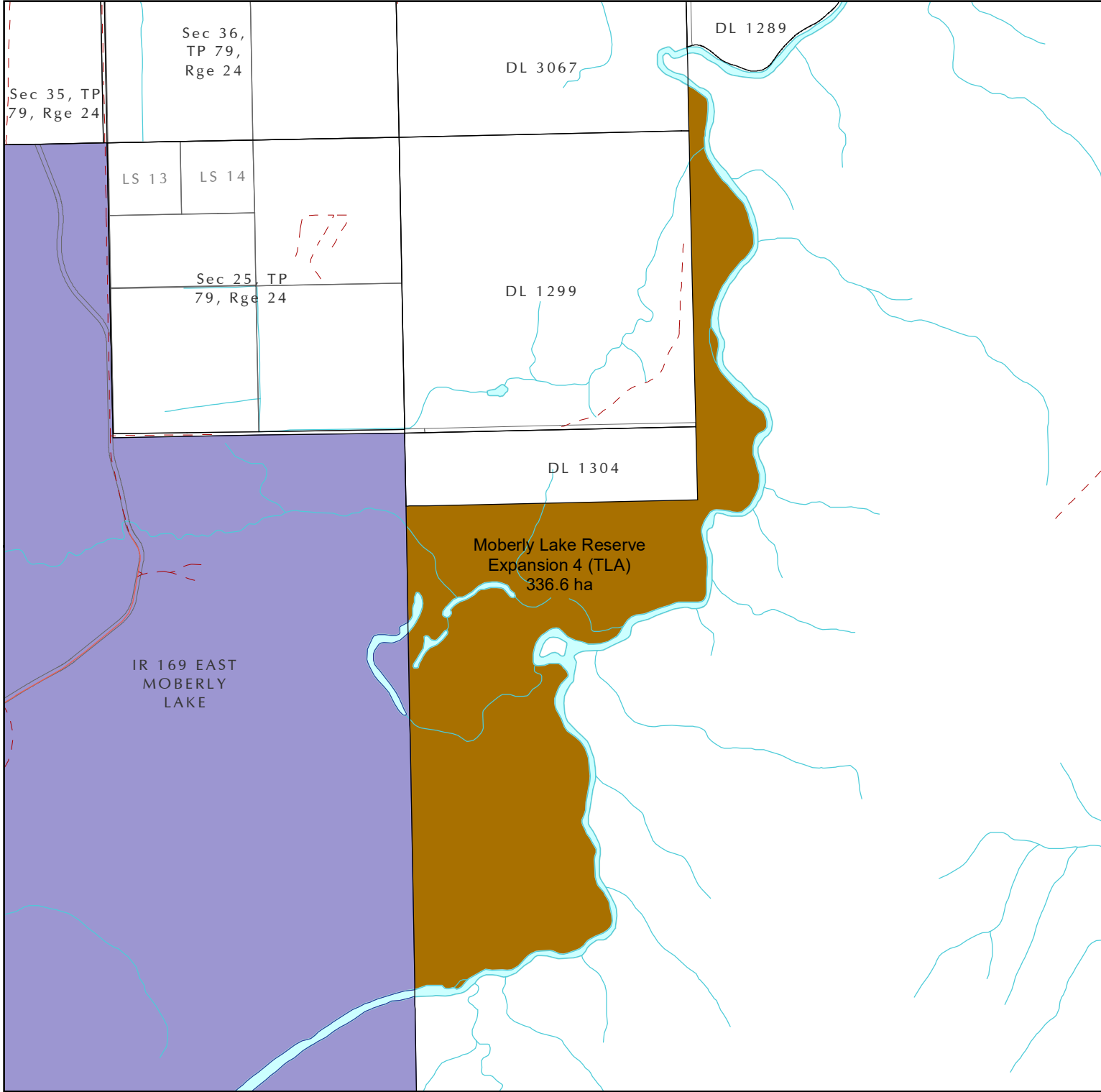

Saulteau First Nation TLA Consultation Moberly Lake Reserve Expansion 4

- TLA Area of Interest
- Saulteau Indian Reserve
- Other Indian Reserve
- Park or Protected Area

THE INFORMATION PRESENTED ON THIS MAP IS PROVIDED WITHOUT PREJUDICE FOR THE PURPOSES OF TREATY NEGOTIATIONS, IS SUBJECT TO FURTHER REVISIONS, AND DOES NOT CONSTITUTE A LEGAL DEFINITION.

DRAFT

1:30,000

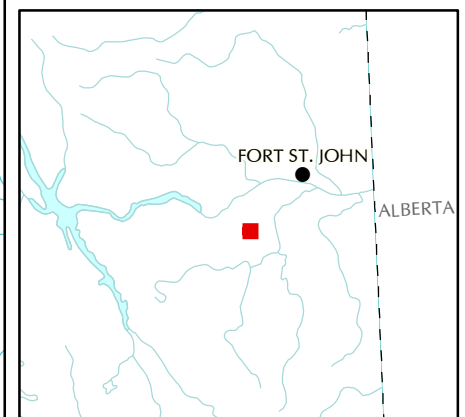
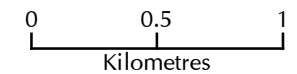

Produced by: GeoBC
Created by: Decision Support Section
Coordinate System: NAD 1983 UTM Zone 10N
Produced for:
Ministry of Indigenous Relations and Reconciliation

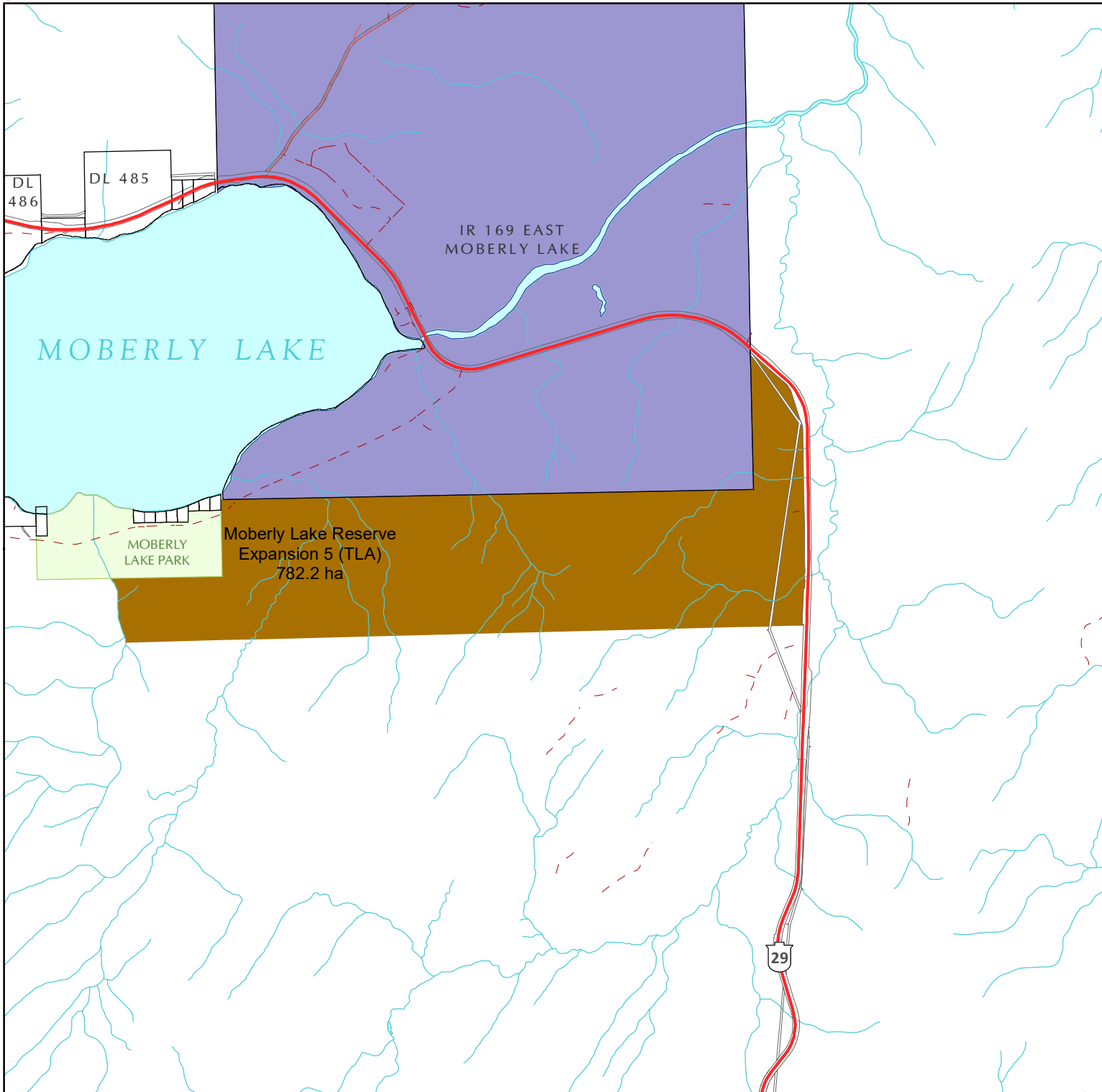

Saulteau First Nation TLA Consultation Moberly Lake Reserve Expansion 5

- TLA Area of Interest
- Saulteau Indian Reserve
- Other Indian Reserve
- Park or Protected Area

THE INFORMATION PRESENTED ON THIS MAP IS PROVIDED WITHOUT PREJUDICE FOR THE PURPOSES OF TREATY NEGOTIATIONS, IS SUBJECT TO FURTHER REVISIONS, AND DOES NOT CONSTITUTE A LEGAL DEFINITION.

DRAFT

1:50,000

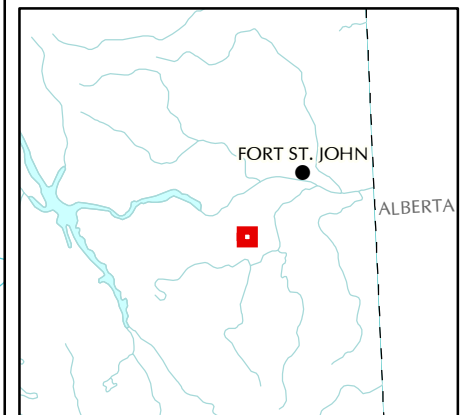
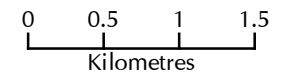

Produced by: GeoBC
Created by: Decision Support Section
Coordinate System: NAD 1983 UTM Zone 10N
Produced for:
Ministry of Indigenous Relations and Reconciliation

Saulteau First Nation TLA Consultation Moberly Lake Reserve Expansion 6

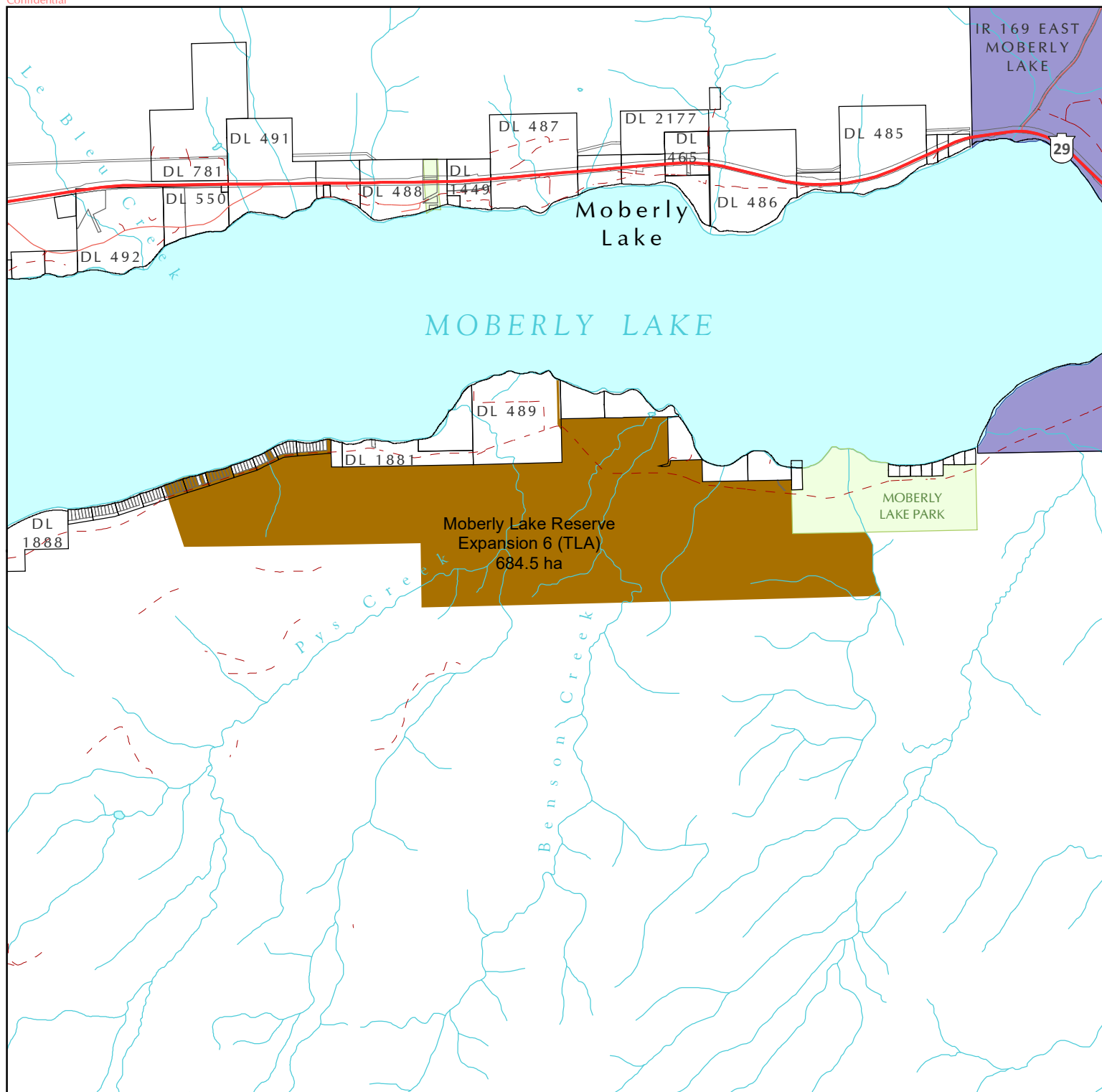

- TLA Area of Interest
- Saulteau Indian Reserve
- Other Indian Reserve
- Park or Protected Area

THE INFORMATION PRESENTED ON THIS MAP IS PROVIDED WITHOUT PREJUDICE FOR THE PURPOSES OF TREATY NEGOTIATIONS, IS SUBJECT TO FURTHER REVISIONS, AND DOES NOT CONSTITUTE A LEGAL DEFINITION.

DRAFT

1:50,000

0 0.5 1 1.5
Kilometres

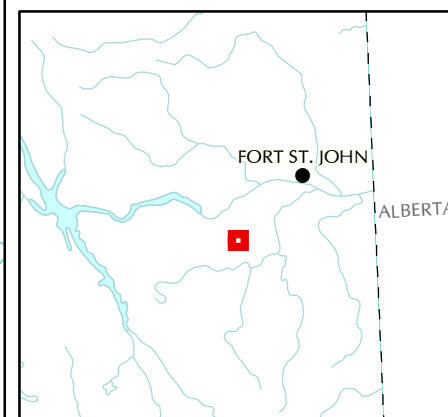

Produced by: GeoBC
Created by: Decision Support Section
Coordinate System: NAD 1983 UTM Zone 10N
Produced for:
Ministry of Indigenous Relations and Reconciliation

Saulteau First Nation TLA Consultation Moberly Lake Reserve Expansion 7

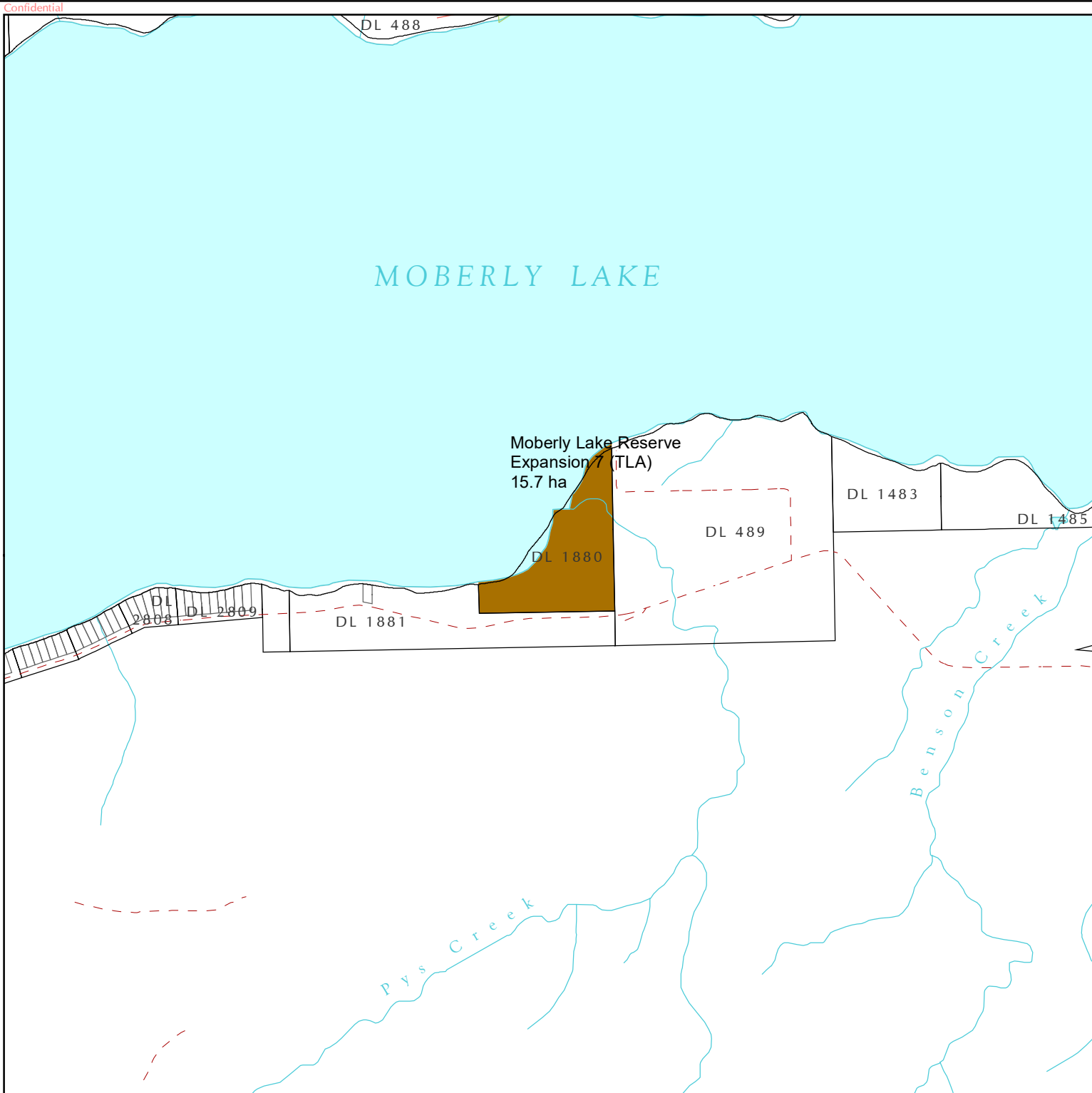

- TLA Area of Interest
- Saulteau Indian Reserve
- Other Indian Reserve
- Park or Protected Area

THE INFORMATION PRESENTED ON THIS MAP IS PROVIDED WITHOUT PREJUDICE FOR THE PURPOSES OF TREATY NEGOTIATIONS, IS SUBJECT TO FURTHER REVISIONS, AND DOES NOT CONSTITUTE A LEGAL DEFINITION.

DRAFT

1:20,000

0 0.5
Kilometres

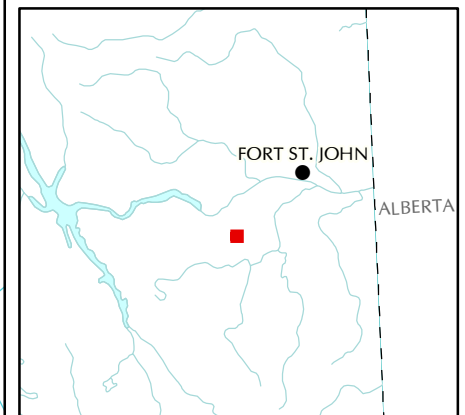

Produced by: GeoBC
Created by: Decision Support Section
Coordinate System: NAD 1983 UTM Zone 10N
Produced for:
Ministry of Indigenous Relations and Reconciliation