

Clayton Station

190 Street and Fraser Highway

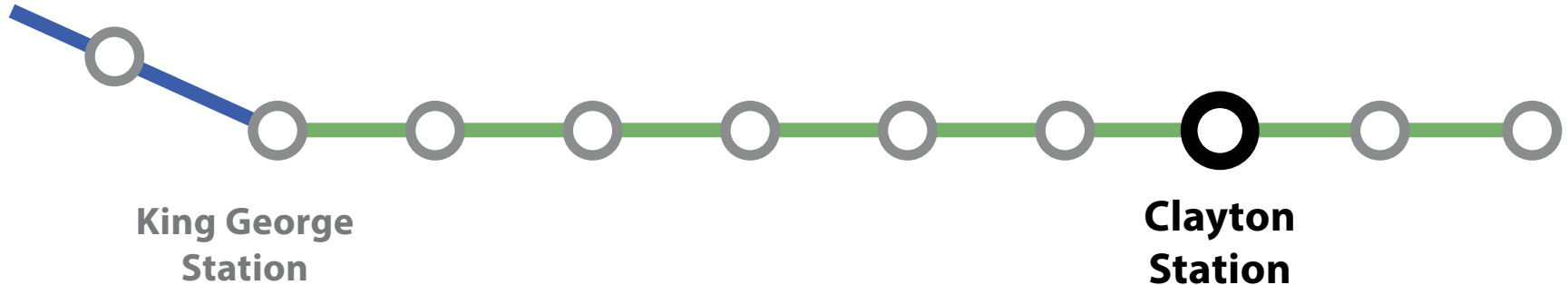

Clayton Station

Conceptual rendering, subject to change; does not reflect future transit-oriented development



Platform enhanced with coloured glass panel



Station specific design on exterior cladding panels

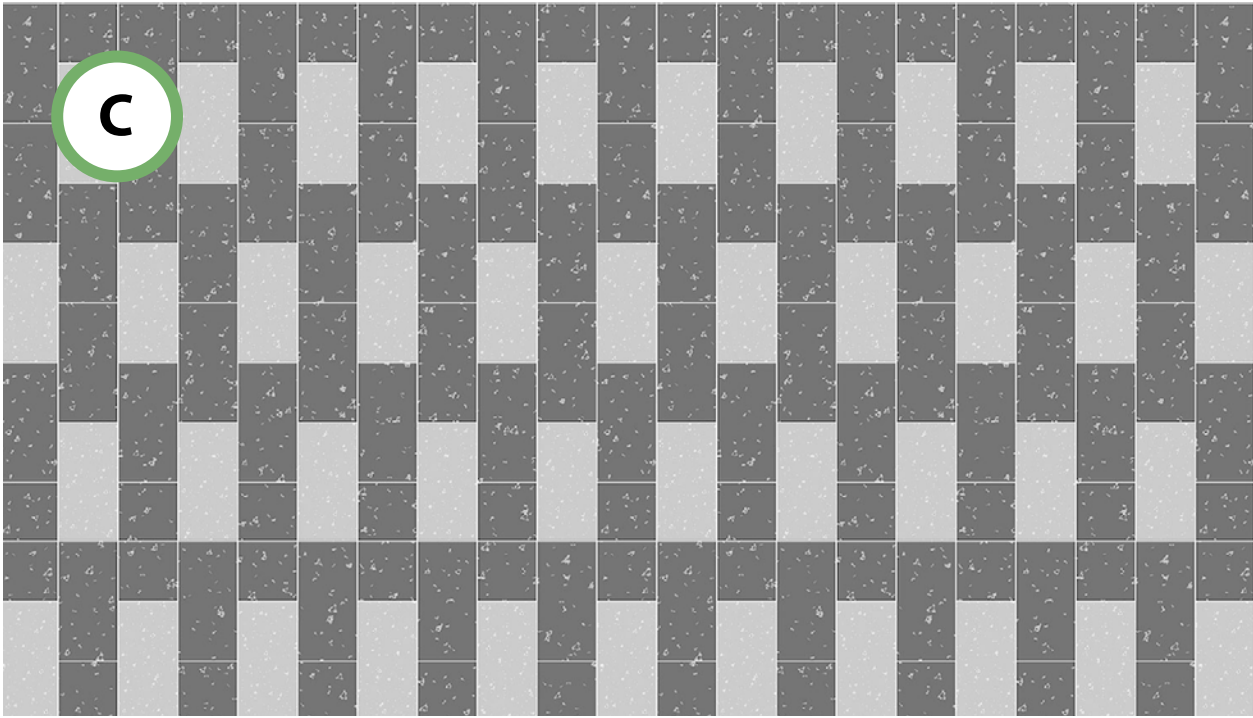

Plaza paving pattern reflecting station location

Clayton Station

190 Street and Fraser Highway

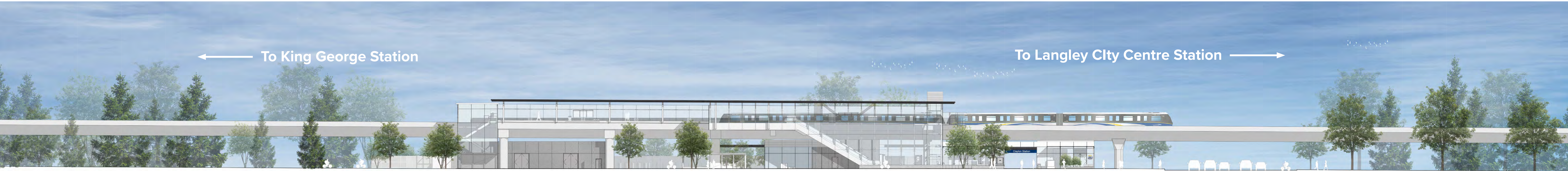
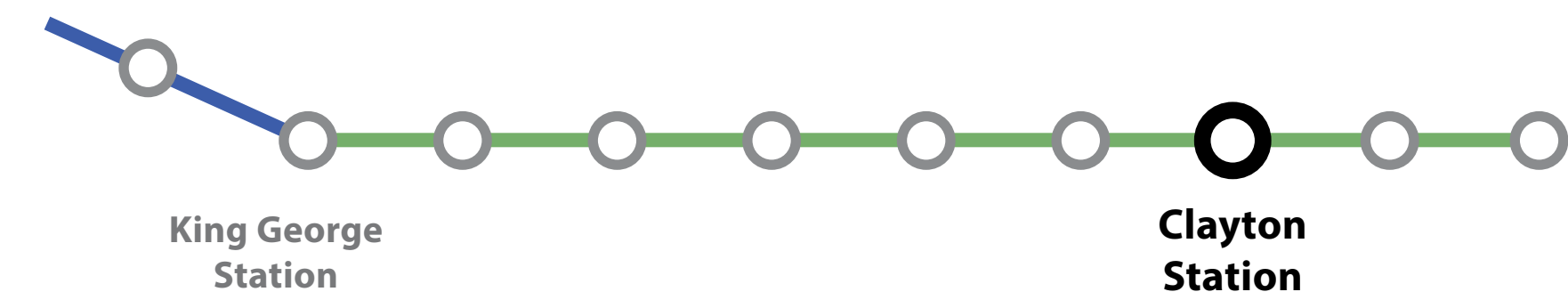

South elevation streetscape

Conceptual rendering, subject to change; does not reflect future transit-oriented development

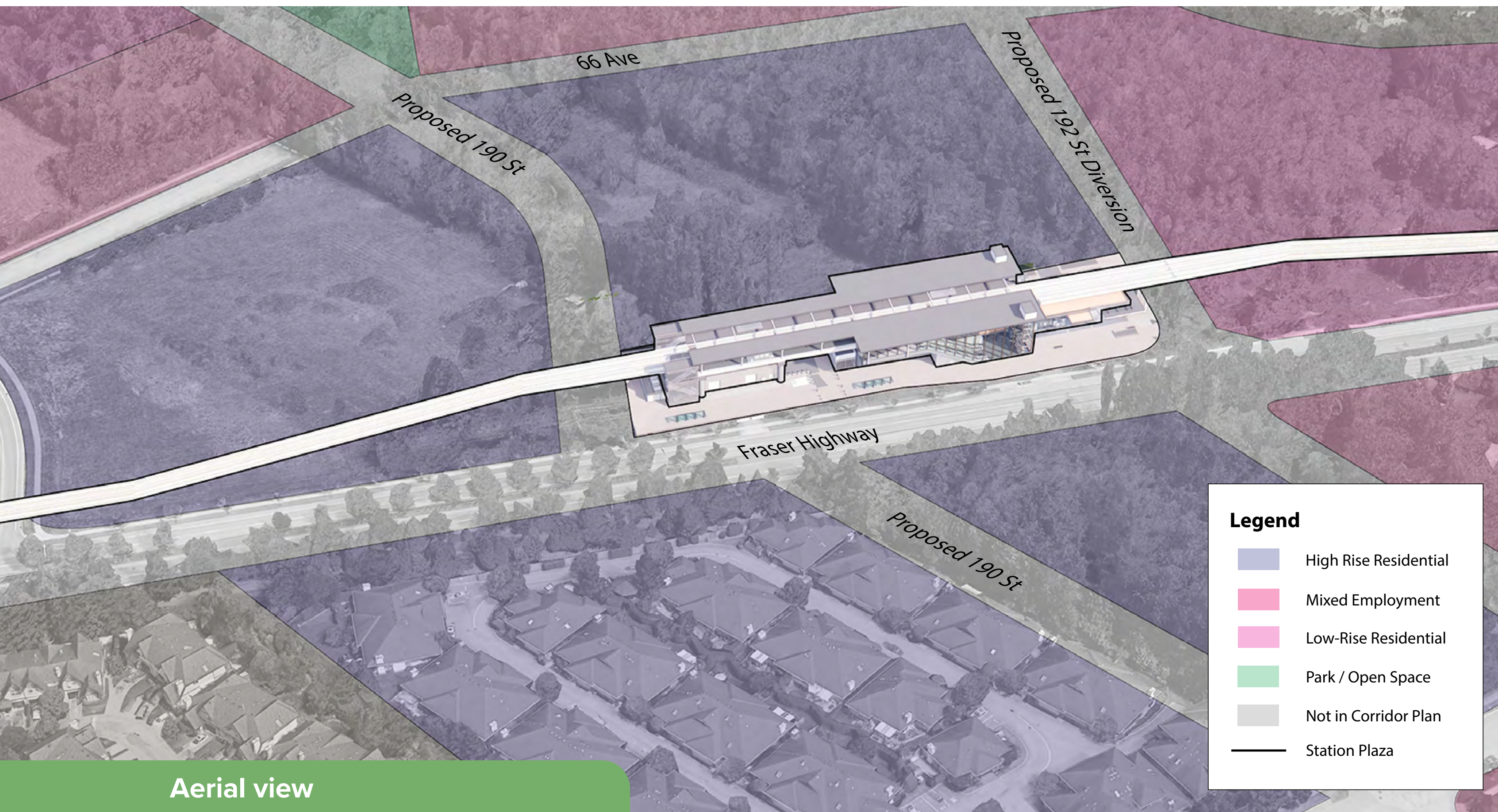

Aerial view

Source: Clayton Corridor Plan 2023

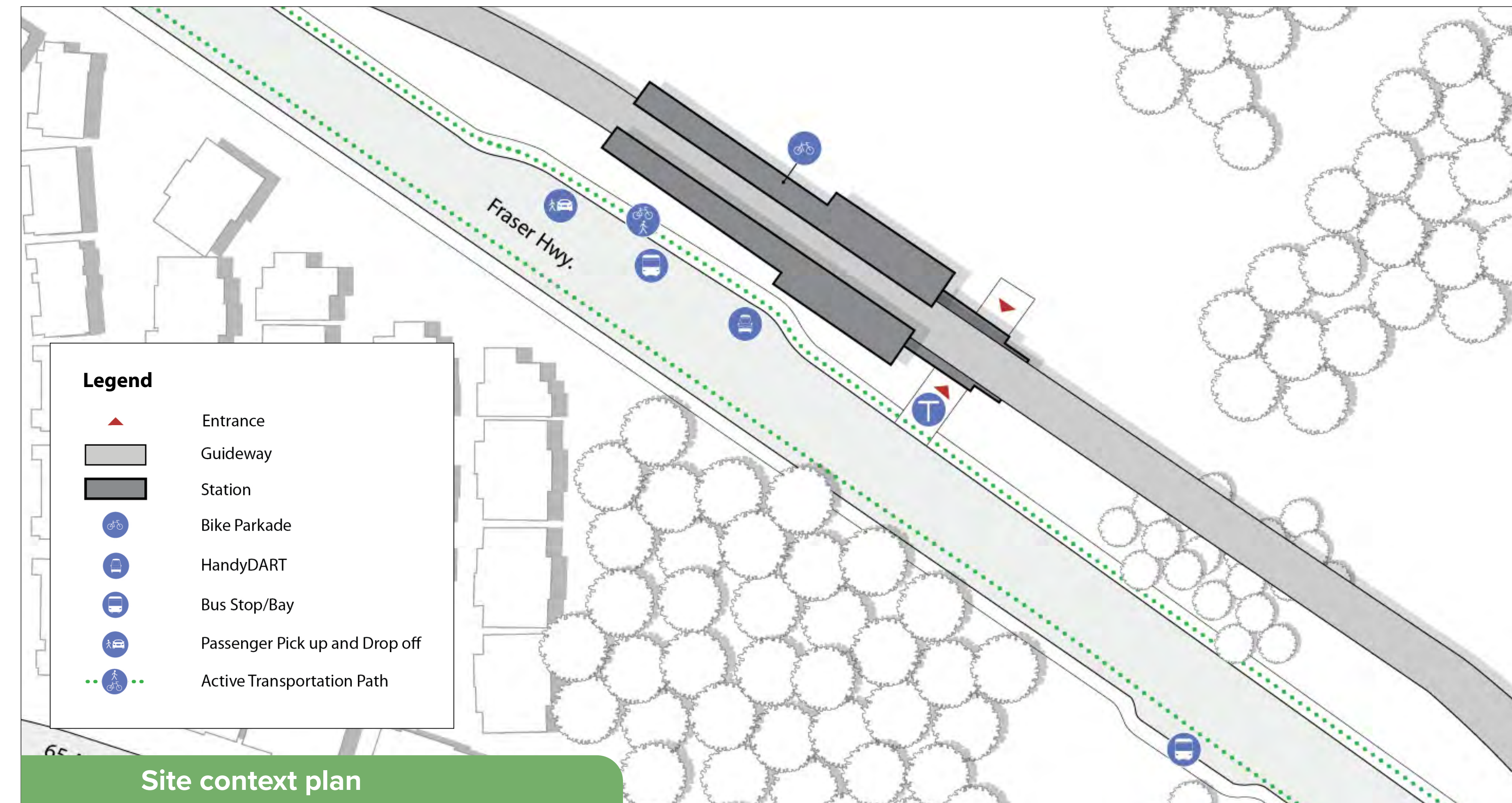

Site context plan

Clayton Station

190 Street and Fraser Highway

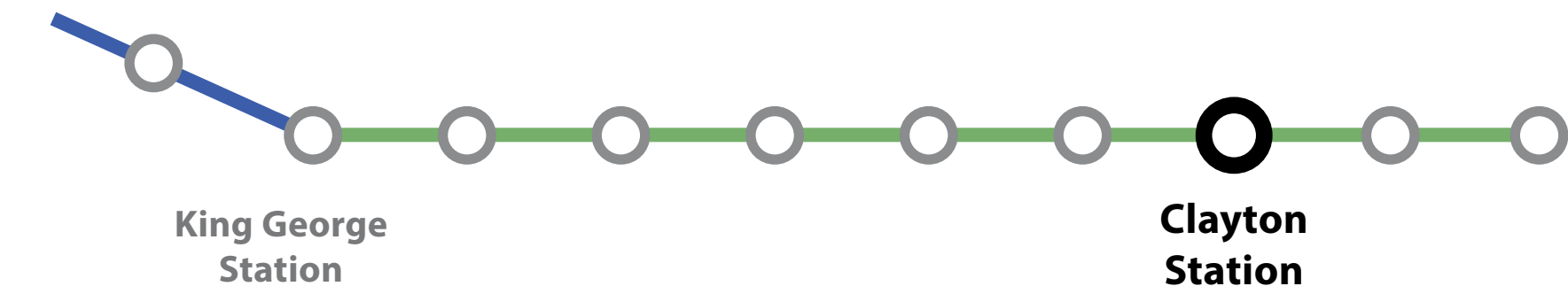

Clayton Station features:

- Designated accessible pathways at the station and within the plaza
- Improved accessible wayfinding, including tactile and contrasting colour tiles
- Washroom available with the assistance of a SkyTrain attendant
- Secure enclosed bike parkade

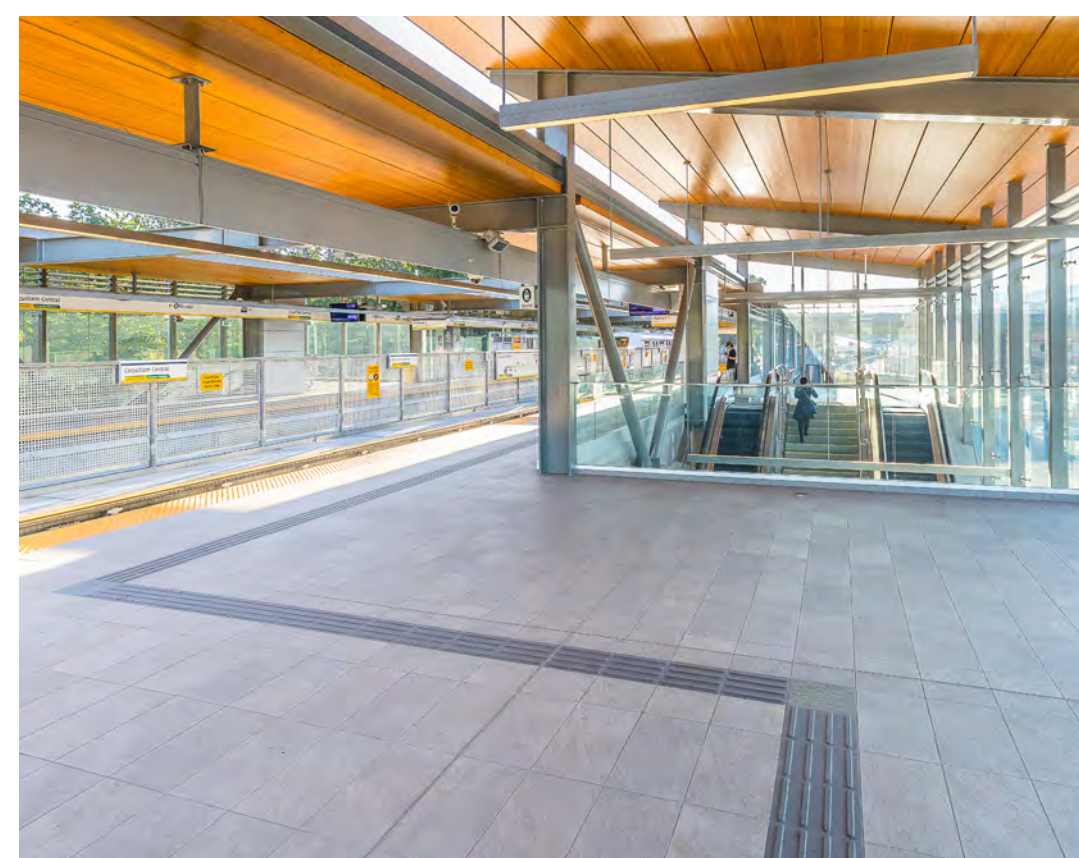
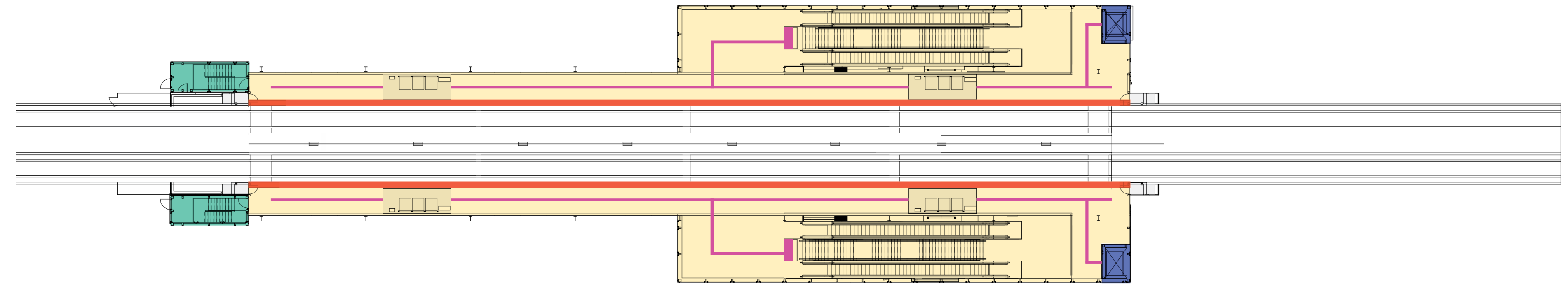

Example of tactile wayfinding tile in contrasting colour at the platform

