

# Fleetwood Station

160 Street and Fraser Highway



Fleetwood Station

Conceptual rendering, subject to change; does not reflect future transit-oriented development



Platform enhanced with coloured glass panel



Station specific design on exterior cladding panels

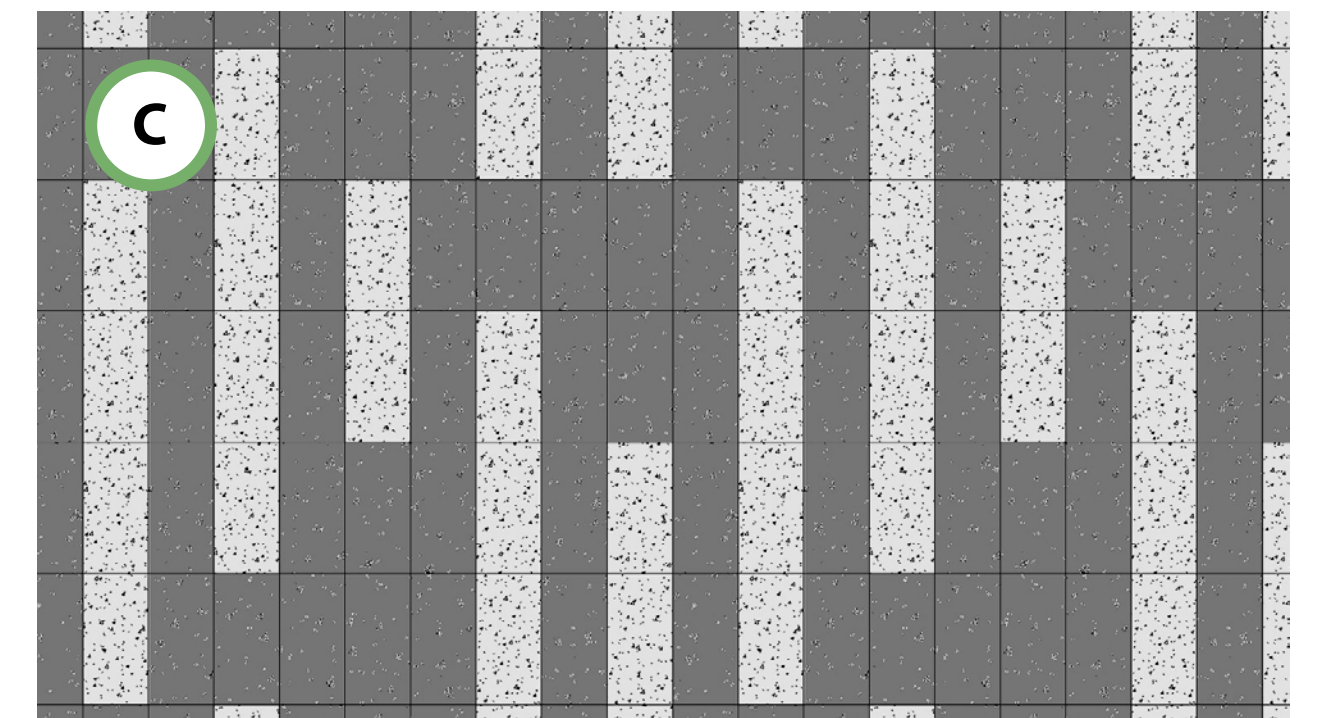

Plaza paving pattern reflecting station location

# Fleetwood Station

160 Street and Fraser Highway



South elevation streetscape

Conceptual rendering, subject to change; does not reflect future transit-oriented development



Aerial view

Source: The Fleetwood Plan 2022

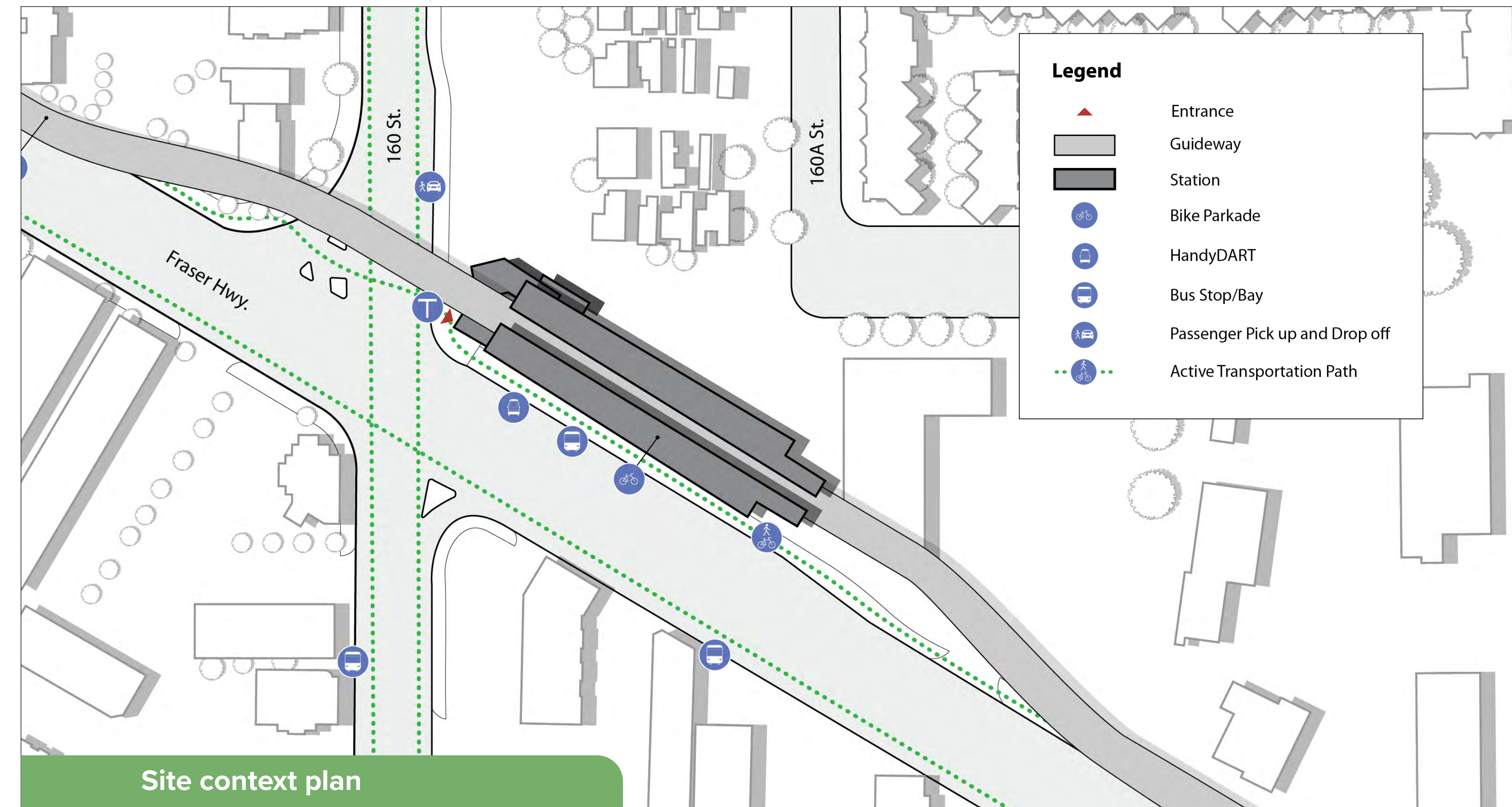

Site context plan

# Fleetwood Station

160 Street and Fraser Highway

## Fleetwood Station features:

- Designated accessible pathways at the station and within the plaza
- Improved accessible wayfinding, including tactile and contrasting colour tiles
- Washroom available with the assistance of a SkyTrain attendant
- Secure enclosed bike parkade

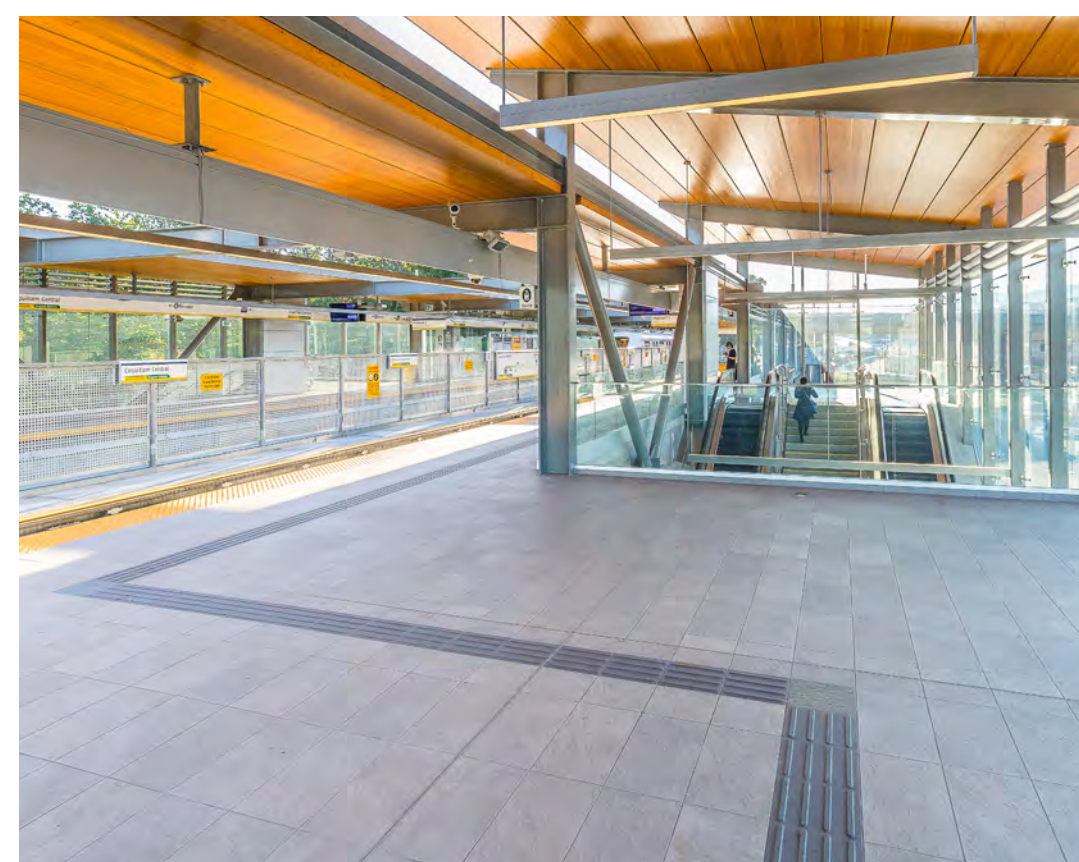

Example of tactile wayfinding tile in contrasting colour at the platform

Legend	
	Platform Edge Tactile Warning
	Tactile Wayfinding Tile
	Accessible Path
	Elevator
	Fare Paid Zone
	Non-Public Service Rooms
	Commerical Retail Unit
	Emergency Exit Stairs

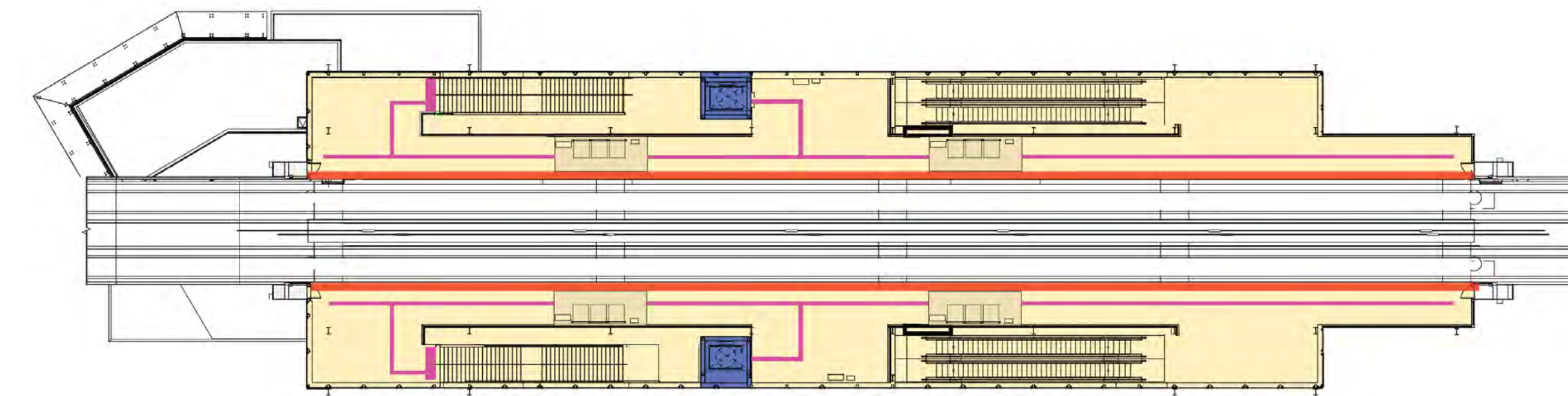

Platform floor plan

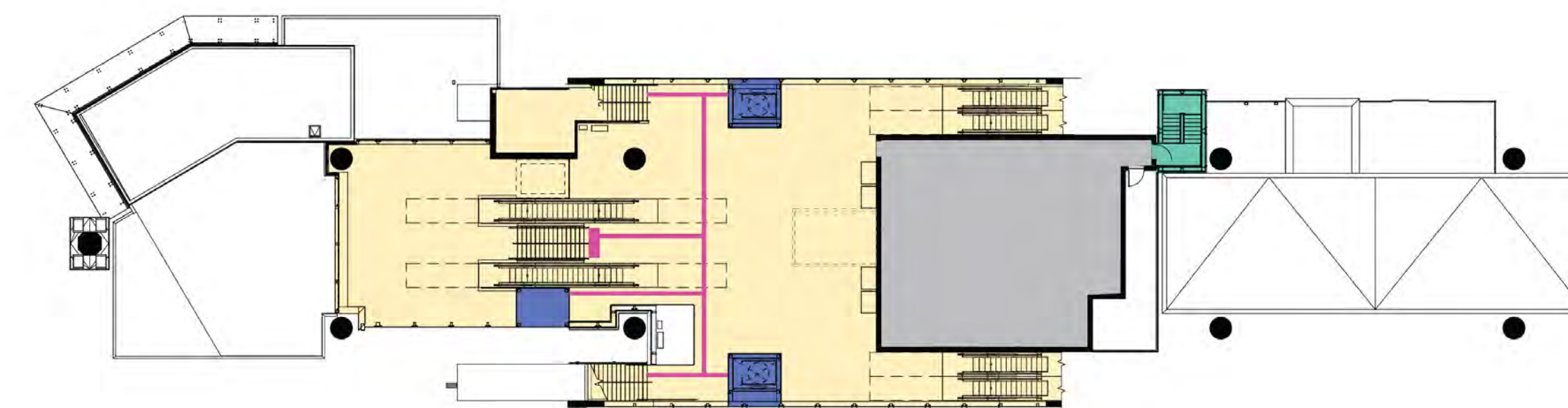

Mezzanine floor plan

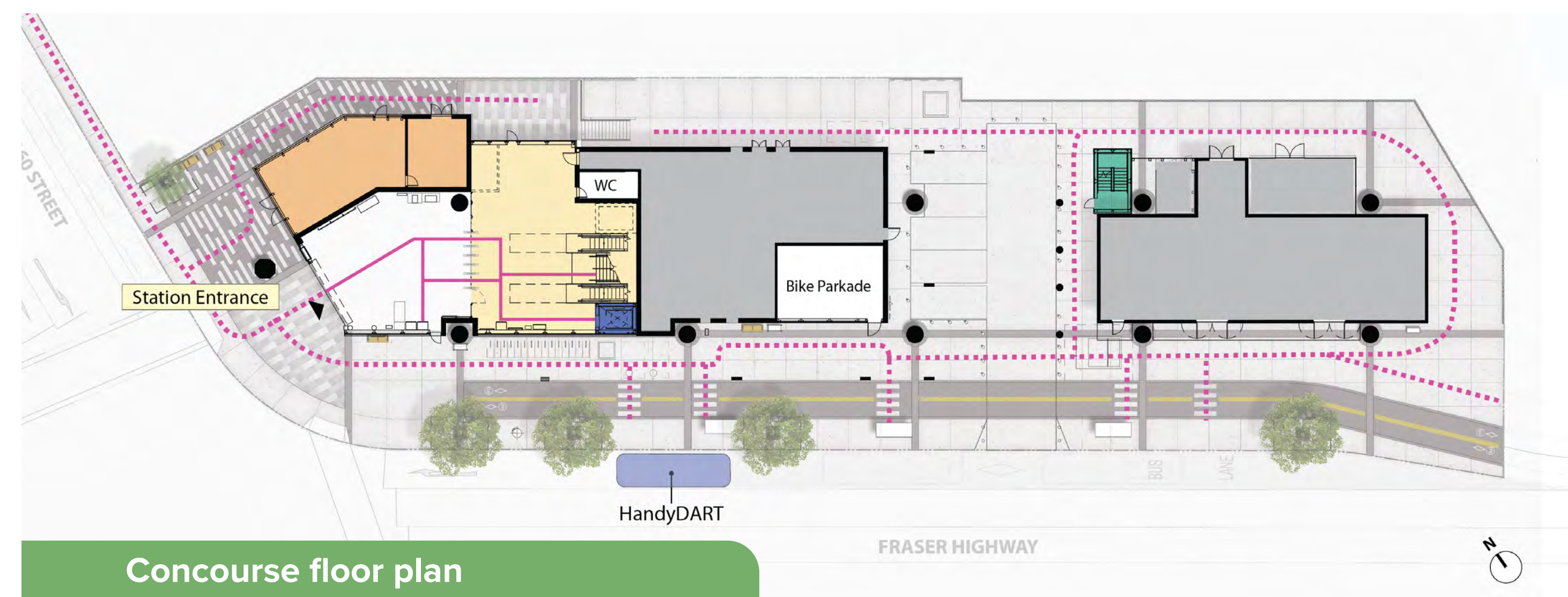

Concourse floor plan